

PIPE CAMERA

Double Arm Bracket

DWC-B1362TIR650

DWC-B1363D

DWC-B1363TIR

DWC-B1365T

DWC-B1367WD

DWC-B1367WTIR

DWC-B1367WTIR650

DWC-B2382TIR

ABOUT MANUAL

Before installing and using the camera, please read this manual carefully.
Be sure to keep it handy for future reference.

PRECAUTIONS

- Do not open or modify.
- Do not open the case except during maintenance and installation, for it may be dangerous and can cause damages.
- Do not put objects into the unit.
- Keep metal objects and flammable substances from entering the camera. It can cause fire, short-circuits, or other damages.
- Be careful when handling the unit.
- To prevent damages, do not drop the camera or subject it to shock or vibration.
- Do not install near electric or magnetic fields.
- Protect from humidity and dust.
- Protect from high temperature.
- Be careful when installing near the ceiling of kitchen or a boiler room, as the temperature may rise to high levels.
- Cleaning
To remove dirt from the case, moisten a soft cloth with a soft detergent solution and wipe.
- Mounting Surface.
The material of the mounting surface must be strong enough to support the camera.

FCC COMPLIANCE

This equipment has been tested and found to comply with the limits for a Class B digital device, pursuant to part 15 of the FCC rules. These limits are designed to Provide reasonable protection against harmful interference. when the equipment is operated in a residential environment. This equipment generates, uses, and radiates radio frequency energy; and if it is not installed and used in accordance with the instruction manual, it may cause harmful interference to radio communications.

WARNING : Changes or modifications are not expressly approved by the manufacturer.

TROUBLESHOOTING

Before sending your camera for repair, check the following or contact our technical specialist.

No VIDEO

Check the coaxial cable and make sure it is connected securely.

Check the lens' iris adjustment at the menu setup of the camera.

Check the power supply and make sure the camera has the proper voltage and current.

Out-of-Focus VIDEO

Check the clear dome cover and the lens for dirt or fingerprints. Use a soft cloth and gently clean.

Check the lens manual focal and zoom adjustment. Field test monitor is recommended.

PART & DESCRIPTIONS*

DWC-B1362TIR650, B1363TIR, B1367WTIR, B1367WTIR650
DWC-B1363D, B1365T, B1367WD

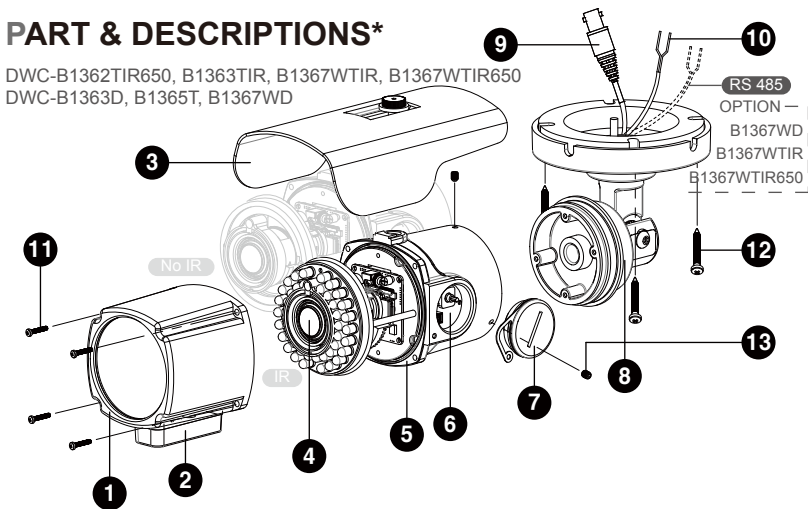

1 Front Case

2 Zoom, Focus Housing

3 Sunshield

4 Lens

5 Rear Case

6 Control Board

7 Con Cap

8 Double Arm Bracket

9 BNC Jack

10 Power Input Connector
DC 12V / AC24V Voltage

11 Assembly Screw

12 Fixing Screw

13 Set Screw

DWC-B2382TIR

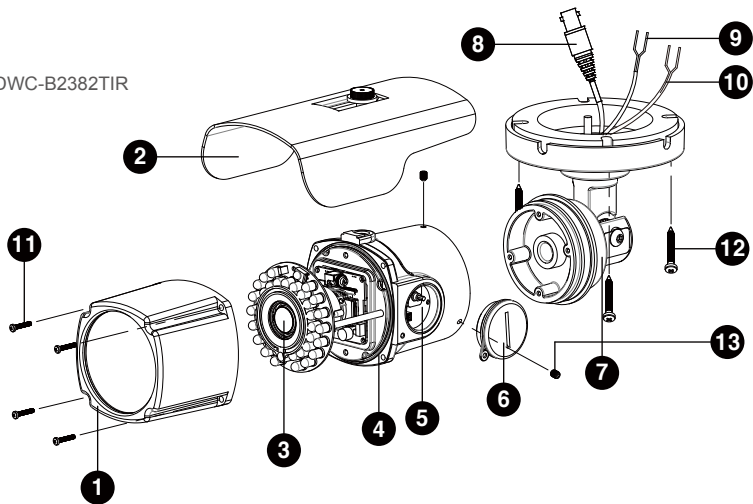

1 Front Case

2 Sunshield

3 Lens

4 Rear Case

5 Control Board

6 Con Cap

7 Double Arm Bracket

8 BNC Jack

9 Power Input Connector
DC 12V / AC24V Voltage

10 RS 485 (EK:D+, WH:D-)

11 Assembly Screw

12 Fixing Screw

13 Set Screw

DIMENSIONS IN MILLIMETERS*

DWC-B1362TIR650, B1363TIR, B1367WTIR, B1367WTIR650

DWC-B1363D, B1365T, B1367WD

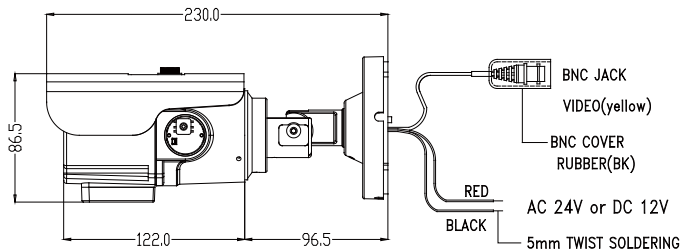

(OPTION)
CABLE LENGTH
STANDARD : 13.78 (350.0mm)

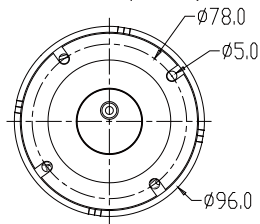
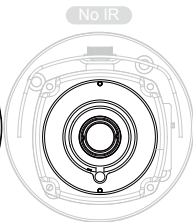
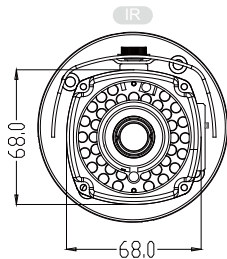

DWC-B2382TIR

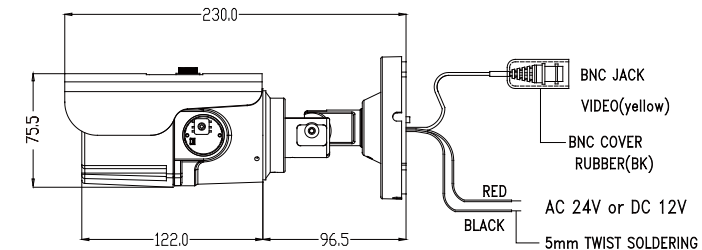

(OPTION)
CABLE LENGTH
STANDARD : 13.78 (350.0mm)

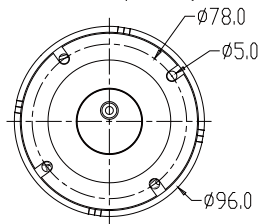
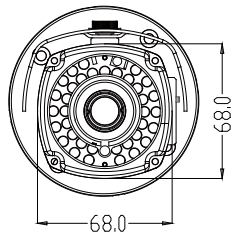

INSTALLATION*

Included with DW Pipe Camera

1. User Manual
2. Mounting Template
3. Four(4) Screw and Four(4) Dry Wall Anchors
4. 2nd Video Jack
5. Tool
6. L-Wrench
7. IR Remote Controller



MOUNTING ON ELECTRICAL JUNCTION BOX*

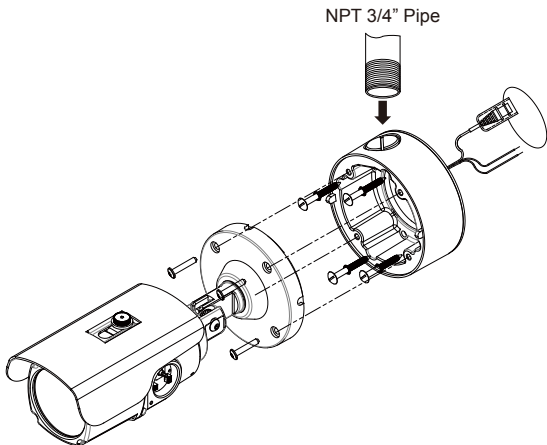

NOTE : Screws required electrical junction boxes are not supplied. These screws are readily available at well-stocked electrical supply store.

CONNECTING TO MONITORS*

Follow the diagram below to make proper connections to the CRT Monitor or the Monitor.

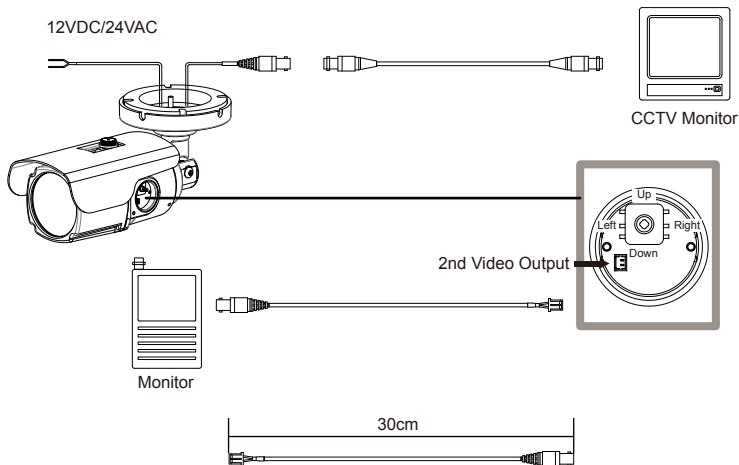

- Power connection - 12VDC/24VAC Dual Voltage(Auto polarity detection and protection)
- All camera are equipped with a service monitor output on the camera module.

CONTROL BOARD*

DWC-B1362TIR650, B1363TIR, B1367WTIR, B1367WTIR650

DWC-B1363D, B1365T, B1367WD

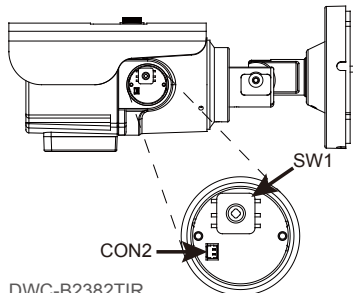

- [1] SW1 Joystick
The function of SW1 joystick are camera zoom in/out and OSD control.
- [2] CON2
Video Test output connector.

DWC-B2382TIR

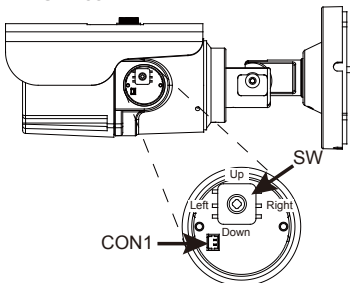

- [1] SW
Functional control of O.S.D
(On Screen Display)
- [2] CON1
Second Video output connector.
- [3] Functional when using omni Focus Lens Option.
*Zoom Out = Wide setting
Choose the zoom out(=wide) position and press the button "DOWN" to save it.
*Zoom In = Tele setting
Choose the zoom in (=Tele) position and press the button "UP" to save it.

ADJUSTING THE VARI-FOCAL DC AUTO IRIS LENS*

Follow the instructions provided below to make any lens adjustments.

DWC-B1362TIR650, B1363TIR, B1367WTIR, B1367WTIR650

DWC-B1363D, B1365T, B1367WD

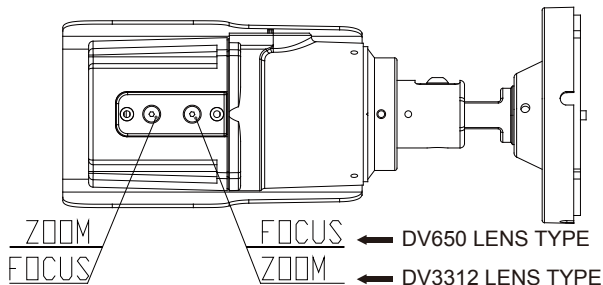

DV650 LENS TYPE

DWC-B1362TIR650
DWC-B1367WTIR650

DV3312 LENS TYPE

DWC-B1363D
DWC-B1363TIR
DWC-B1365T
DWC-B1367WD
DWC-B1367WTIR

- Rotate Zoom lever to display desired view.
- Rotate Focus lever to match the focus.

CAMERA SETTING ANGLE*

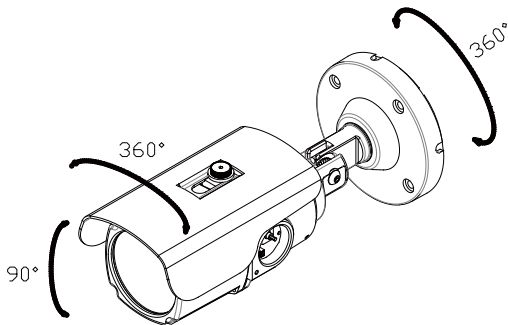

CAUTION :

1. Do not rotate ① more than 360°
2. Do not twist ② many times unnecessarily.

FEATURES*

B1362TIR650

- 1/3" Sony Super HAD II CCD
- 540 TV Lines
- 6 ~ 50mm Varifocal Auto Iris Lens
- 100ft Range IR with Intelligent Camera Sync
- True Day & Night / TDN5 (Electro Magnetic Mechanism)
- DRC (Dynamic Range Compressor)
- HME (Highlight Masking Exposure)
- SLC (Side Light Compensation)
- AGC / BLC / AWB
- Negative Imaging
- Mirror Image Control
- RS485 Built-In
- Programmable Privacy Zone (4) & Motion Detection
- Easy Icon Driven OSD Menu with Built-In Joystick
- Auto Sensing 12VDC or 24VAC with Line Lock
- Secondary Video-BNC Output

FEATURES*

B1363D

- 1/3" High Resolution CCD
- 560 TV Lines
- 3.3 ~ 12mm Varifocal Auto Iris Lens
- Electronic Day and Night
- Star-Light (Super Low Light Technology)
- 3D-DNR (3D Digital Noise Reduction)
- DRC (Dynamic Range Compressor)
- HME (Highlight Masking Exposure)
- AGC / BLC / AWB
- Horizontal / Vertical Mirror
- 32x Digital Zoom / Negative Imaging
- RS485 Built-In
- Programmable Privacy Zone (8) & Motion Detection(4)
- Easy Icon Driven OSD Menu with Built-In Joystick
- Auto Sensing 12VDC or 24VAC with Line Lock
- Secondary Video-BNC Output

FEATURES*

B1363TIR

- 1/3" High Resolution CCD
- 560 TV Lines
- 3.3 ~ 12mm Varifocal Auto Iris Lens
- 100ft Range IR with Intelligent Camera Sync
- TDN (True Day and Night / TDN5)
- Star-Light (Super Low Light Technology)
- DRC (Dynamic Range Compressor)
- 3D-DNR (3D Digital Noise Reduction)
- HME (Highlight Masking Exposure)
- AGC / BLC / AWB
- Horizontal / Vertical Mirror
- SMART IR
- 32x Digital Zoom / Negative Imaging
- RS485 Built-In
- Programmable Privacy Zone (8) & Motion Detection(4)
- Easy Icon Driven OSD Menu with Built-In Joystick
- Auto Sensing 12VDC or 24VAC with Line Lock
- Secondary Video-BNC Output

FEATURES*

B1365T

- 1/3" Pixim Seawolf CMOS Sensor
- 690 TV Lines (H:540 TV Lines, V:460 TV Lines)
- 3.3 ~ 12mm Varifocal Auto Iris Lens
- TDN (True Day and Night / TDN5)
- Powerful Wide Dynamic Range
- Star-Light (Super Low Light Technology)
- 3D-DNR (3D Digital Noise Reduction)
- Ultra Low Light Sensitivity
- Smear Canceling Circuit
- Horizontal / Vertical Mirror
- 8x Digital Zoom
- Low Power Consumption
- RS485 Built-In
- Programmable Privacy Zone (6) & Motion Detection(4)
- Easy Driven OSD Menu with Built-In Joystick
- Auto Sensing 12VDC or 24VAC with Line Lock
- Secondary Video-BNC Output

FEATURES*

B1367WD

- 1/3" Sony Super HAD II CCD
- 580 TV Lines
- 3.3 ~ 12mm Varifocal Auto Iris Lens
- Electronic Day & Night
- Star-Light (Super Low Light Technology)
- EWDR (Electronic Wide Dynamic Range)
- 3D-DNR (3D Digital Noise Reduction)
- HME (Highlight Masking Exposure)
- SLC (Side Light Compensation)
- AGC / BLC / AWB
- Negative Imaging
- 3X Digital Zoom
- Mirror Image Control
- RS485 Built-In
- Programmable Privacy Zone (6) & Motion Detection
- Easy Icon Driven OSD Menu with Built-In Joystick
- Auto Sensing 12VDC or 24VAC with Line Lock
- Secondary Video-BNC Output

FEATURES*

B1367WTIR

- 1/3" Sony Super HAD II CCD
- 580 TV Lines
- 3.3 ~ 12mm Varifocal Auto Iris Lens
- 100ft Range IR with Intelligent Camear Sync
- True Day & Night / TDN5(Electro Magnetic Mechanism)
- Star-Light (Super Low Light Technology)
- EWDR (Electronic Wide Dynamic Range)
- 3D-DNR (3D Digital Noise Reduction)
- HME (Highlight Masking Exposure)
- SLC (Side Light Compensation)
- AGC / BLC / AWB
- Negative Imaging
- 3X Digital Zoom
- Mirror Image Control
- RS485 Built-In
- Programmable Privacy Zone (6) & Motion Detection
- Easy Icon Driven OSD Menu with Built-In Joystick
- Auto Sensing 12VDC or 24VAC with Line Lock
- Secondary Video-BNC Output

FEATURES*

B1367WTIR650

- 1/3" Sony Super HAD II CCD
- 580 TV Lines
- 6 ~ 50mm Varifocal Auto Iris Lens
- 250ft Range IR with Intelligent Camear Sync
- True Day & Night / TDN5(Electro Magnetic Mechanism)
- Star-Light (Super Low Light Technology)
- EWDR (Electronic Wide Dynamic Range)
- 3D-DNR (3D Digital Noise Reduction)
- HME (Highlight Masking Exposure)
- SLC (Side Light Compensation)
- AGC / BLC / AWB
- Negative Imaging
- 3X Digital Zoom
- Mirror Image Control
- RS485 Built-In
- Programmable Privacy Zone (6) & Motion Detection
- Easy Icon Driven OSD Menu with Built-In Joystick
- Auto Sensing 12VDC or 24VAC with Line Lock
- Secondary Video-BNC Output









FEATURES*

B2382TIR

- 1/3" Sony Super HAD II CCD
- 580 TV Lines
- OMNI-Focus 2.9 ~ 8.5mm 3X Motorized Zoom, Auto Iris
- 100ft Range IR with Intelligent CAMEAR Sync
- True Day & Night / TDN5(Electro Magnetic Mechanism)
- Star-Light (Super Low Light Technology)
- EWDR (Electronic Wide Dynamic Range)
- 3D-DNR (3D Digital Noise Reduction)
- HME (Highlight Masking Exposure)
- SLC (Side Light Compensation)
- AGC / BLC / AWB
- Negative Imaging
- 3X Digital Zoom
- Mirror Image Control
- RS485 Built-In
- Programmable Privacy Zone (6) & Motion Detection
- Easy Icon Driven OSD Menu with Built-In Joystick
- Auto Sensing 12VDC or 24VAC with Line Lock
- Secondary Video-BNC Output

MODULE OSD MENU*

B1362TIR650

EXPOSURE		COLOR		DAY&NIGHT	
	<ul style="list-style-type: none"> — LENS — E. SHUTTER — BLC — AGC 		<ul style="list-style-type: none"> — WB MODE — R-Y GAIN — B-Y GAIN 		<ul style="list-style-type: none"> — D&N MODE
FUNCTION		MOTION		PRIVACY	
	<ul style="list-style-type: none"> — MIRROR — SHARPNESS — GAMMA — SLC — HME — DRC 		<ul style="list-style-type: none"> — ALARM 		<ul style="list-style-type: none"> — MASK 1 — MASK 2 — MASK 3 — MASK 4 — COLOR SET
SYNC		SETUP		EXIT	
	<ul style="list-style-type: none"> — SYNC MODE 		<ul style="list-style-type: none"> — CAMERA ID — TITLE EDIT — TITLE RESET — TITLE POS. — DPC SET — LANGUAGE — PC CONT. 		<ul style="list-style-type: none"> — EXIT — SAVE & EXIT — FACTORY SET

EXPOSURE

LENS	MANUAL (ELC LEVEL : 0 ~ 100) / DC (DC LEVEL : 0 ~ 31)
E.SHUTTER	1/60 / 1/100FLC / 1/250 ~ 100000
BLC	OFF / ON BLC (Back Light Compensation)
AGC	OFF ~ 36dB AGC (AUTO GAIN CONTROL)

COLOR

WB MODE	AWC / ATW / MANUAL / PUSH LOCK
R-Y GAIN	0 ~ 255
B-Y GAIN	0 ~ 255

DAY & NIGHT

Day & Night Mode	AUTO / COLOR / BW COLOR → BW : Switching from COLOR to BW; If the number is higher, the camera will only switch during a super low light condition. BW → COLOR : Switching from BW to COLOR; This number should be always lower than COLOR to BW Read Time : time interval to switch from COLOR to BW
	COLOR
	B&W : (BURST : OFF/ON) When the burst is OFF, the picture will have less noise.

FUNCTION

MIRROR	OFF / ON
SHARPNESS	0 ~ 49
GAMMA	USER / 0.45 / 0.6 / 1.00
SLC	OFF / ON (0 ~ 50) SLC (Side Light Compensation)
HME	OFF / ON (0 ~ 155) HME (Highlight Masking Exposure)
DRC	OFF / ON DRC (Dynamic Range Compressor)

MOTION

ALARM	OFF / ON
	SET WINDOW
	ALL SET (Set the Entire Screen)
	ALL CLEAR (Clear the Entire Screen)
	SENSITI. (0 ~ 55)
	SHOW INDI. (OFF / ICON / TRACE)
	DELAY OUT(1 ~ 15) Motion Alarm Zoom-In Delay

PRIVACY

MASK 1	OFF / ON ↕
MASK 2	OFF / ON ↕
MASK 3	OFF / ON ↕
MASK 4	OFF / ON ↕
COLOR SET	BLACK / GRAY / COLOR 1~ 6

SYNC

SYNC MODE	INTER. / AUTO
V_PHASE	0 ~ 199









SETUP

CAMERA ID	0 ~ 254
TITLE EDIT	
TITLE RESET	
TITLE POS.	
DPC SET	OFF / ON DPC (Dead Pixel Cancellation)
LANGUAGE	English / Chinese
PC CONT.	OFF / ON

EXIT

EXIT	Exit the menu
SAVE & EXIT	Exit the menu and save the setting
FACTORY SET	Reset the menu setting to factory default

B1363D, B1363TIR

EXPOSURE		COLOR		DAY&NIGHT	
	<ul style="list-style-type: none"> — BRIGHTNESS — SHUTTER — BLC / HME — AGC — STARLIGHT — NIGHT-UP 		<ul style="list-style-type: none"> — WB MODE — R-Y GAIN — B-Y GAIN 		<ul style="list-style-type: none"> — D&N MODE — C-SUP — A-SUP
FUNCTION		MOTION		PRIVACY	
	<ul style="list-style-type: none"> — MIRROR — SHARPNESS — FREEZE — NEG. IMAGE — D-ZOOM — 3D DNR — DRC 		— MOTION		— PRIVACY
SYNC		SETUP		EXIT	
	— SYNC		<ul style="list-style-type: none"> — TITLE EDIT — PC CONTROL (RS485 Control) — LANGUAGE — MONITOR — OSD COLOR — OMNI LENS — DEFECT 		<ul style="list-style-type: none"> — EXIT — SAVE & EXIT — FACTORY SET

EXPOSURE

BRIGHTNESS	0 ~ 100
SHUTTER	1/60 / FLK / 1/250 ~ 10000 / STAR LIGHT x2 ~ x256
BLC/HME	OFF / BLC / HME
AGC	HIGH / MIDDLE / LOW / OFF AGC(Auto Gain Control)
STARLIGHT	AUTO(x2 ~ x256) / OFF
NIGHT-UP	NORMAL / HIGH
EXIT	JUMP

COLOR

WB MODE	AWC / ATW / PUSH LOCK / MANUAL / INDOOR / OUTDOOR
R-Y GAIN	0 ~ 100
B-Y GAIN	0 ~ 100
EXIT	JUMP

DAY & NIGHT

Day & Night Mode	AUTO : READ TIME(0~63) / S-LEVEL / E-LEVEL COLOR → B&W : Switching from COLOR to BW; If the number is higher, the camera will only switch during a super low light condition B&W → COLOR : Switching from BW to COLOR; This number should be always lower than COLOR to BW Read Time : time interval to switch from COLOR to BW
	COLOR
	B&W Mode : BURST (OFF / ON) There is less noise when the BURST is OFF. SMART IR (OFF / ON)
C-SUP	Color Suppression : Color will be reduced at low illumination, if the C-SUP Level is set higher. 0 ~ 63
A-SUP	Aperture Suppression : The sharpness of the edges will be reduced at low illumination, if A-SUP level is set higher. 0 ~ 15
EXIT	JUMP

FUNCTION

MIRROR	OFF / MIRROR / V-FLIP / ROTATE
SHARPNESS	0 ~ 31
FREEZE	OFF / ON
NEG.IMAGE	OFF / ON
D-ZOOM	OFF / ON (x1.0 ~ x32 PTZ)
3D DNR	ON (0~100) / OFF 3D Digital Noise Reduction
DRC	OFF / INDOOR / OUTDOOR Dynamic Range Compressor
EXIT	JUMP

MOTION (OMNI-Plus Camera Only)

MOTION	OFF ON  AREA SELECT (AREA 1~4) AREA SET (POSITION / SIZE) SENSITIVITY (0~40) MOTION TRACE (OFF / ON) MOTION VIEW (OFF / ON) RETURN
EXIT	JUMP

PRIVACY

PRIVACY	OFF ON  AREA SELECT (1~8) AREA SET (POSITION / SIZE) COLOR (0~15) RETURN
EXIT	JUMP

SYNC

SYNC	INTER. / AUTO
EXIT	JUMP

SETUP

TITLE EDIT	OFF / ON
PC CONTROL (RS485 Control)	CAM ID / ID DISPLAY (OFF/ON) / BAUDRATE (2400 / 4800 / 9600 / 19200 / 38400 / 57600) The protocol is fixed pelco-D.
LANGUAGE	ENG / KOR / JPN / CHN1 / CHN2 / RUS / FRAN / SPAN / ITAL
MONITOR	CRT / LCD / USER Select LCD only if the camera is directly connected to the LCD monitor.
OSD COLOR	0 ~ 15
OMNI LENS	OFF (OMNI-Plus Camera Only) ON ↙ ALARM / READ TIME / ALARM ZOOM / STAND BY / RETURN
DEFECT	WHITE DEFECT CANCEL MODE
EXIT	JUMP

EXIT

EXIT
SAVE & EXIT
FACTORY SET

B1365T

EXPOSURE		COLOR		DAY&NIGHT	
	<ul style="list-style-type: none"> └ BRIGHTNESS └ AE PREFERENCE └ BLC └ WDR └ AGC └ STARLIGHT └ METER ZONE 		<ul style="list-style-type: none"> └ WB MODE └ COLOR GAIN 		<ul style="list-style-type: none"> └ D&N MODE └ BW BURST
FUNCTION		MOTION		PRIVACY	
	<ul style="list-style-type: none"> └ MIRROR └ SHARPNESS └ GAMMA └ 3D DNR └ D-ZOOM 		<ul style="list-style-type: none"> └ MOTION └ MOTION ZONE 		<ul style="list-style-type: none"> └ PRIVACY MASK └ MASK COLOR
SYNC		SETUP		EXIT	
	<ul style="list-style-type: none"> └ SYNC 		<ul style="list-style-type: none"> └ PC CONTROL └ TITLE └ LANGUAGE └ OMNI LENS └ FLUORESCENT └ DIGITAL VIDEO └ OUTPUT 		<ul style="list-style-type: none"> └ EXIT └ SAVE & EXIT └ FACTORY SET

EXPOSURE	
BRIGHTNESS	-48 ~ 60
AE PREFERENCE	OUTDOOR / INDOOR
BLC	OFF / BLC (PERCENTILE 10 ~ 50)
WDR	LOW / NORMAL / MEDIUM / HIGH / CUSTOM
AGC	LOW / MEDIUM / HIGH / CUSTOM
STARLIGHT	x2 ~ x64
METER ZONE	ADJUST ZONE 1 / ADJUST ZONE 2
EXIT JUMP	
COLOR	
WB MODE	AWC / ATW(2,000K ~ 11,000K) / PUSH LOCK / MANUAL(KELVIN : 2,000K ~ 11,000K / R/B:RED : -20 ~ 20 BLUE : -20 ~ 20)
COLOR GAIN	-8 ~ 8
EXIT JUMP	
DAY & NIGHT	
D&N MODE	AUTO / AUTO(EXT) / COLOR / B&W
	- AUTO Mode:(READ TIME:0~255/S-LEVEL:0~60/E-LEVEL:0~60/BW AGC:0~60)
	- AUTO(EXT) Mode:(Option-IR LED Mode)
	- COLOR Mode
	- B&W Mode
	BW BURST (OFF / ON)
EXIT JUMP	

FUNCTION	
MIRROR	OFF / MIRROR / V-FLIP / ROTATE
SHARPNESS	-8 ~ 8
GAMMA	25(0.25) ~ 100(1.0)
3D DNR	MOVIE / INFO
D-ZOOM	ZOOM : 1(1.0x) ~ 12(8x) PAN(-100~100) / TILT(-100~100)(Digital Zoom/Pan using the camera mini joystick)
EXIT JUMP	
MOTION	
MOTION	OFF / ON (ACTIVITY THR (0 ~ 255))
MOTION ZONE	- 1 ZONE / 1 ~ 2 ZONE / 1 ~ 3 ZONE / 1 ~ 4 ZONE - ADJUST ZONE 1 (MOVE/MAKES WIDE/MAKES NARROW) - ADJUST ZONE 2 (MOVE/MAKES WIDE/MAKES NARROW) - ADJUST ZONE 3 (MOVE/MAKES WIDE/MAKES NARROW) - ADJUST ZONE 4 (MOVE/MAKES WIDE/MAKES NARROW)
	RETURN
EXIT JUMP	
PRIVACY	
PRIVACY MASK	OFF ON.. - AREA 1 OFF/ON.. (MOVE/MAKES WIDE, MAKES NARROW) - AREA 2 OFF/ON.. (MOVE/MAKES WIDE, MAKES NARROW) - AREA 3 OFF/ON.. (MOVE/MAKES WIDE, MAKES NARROW) - AREA 4 OFF/ON.. (MOVE/MAKES WIDE, MAKES NARROW) - AREA 5 OFF/ON.. (MOVE/MAKES WIDE, MAKES NARROW) - AREA 6 OFF/ON.. (MOVE/MAKES WIDE, MAKES NARROW)
	RETURN
MASK COLOR	WHITE / BLACK /RED
EXIT JUMP	

SYNC

SYNC	INT1(SYNC to 59.94Hz)/INT2(SYNC to 60.01Hz)/LL(LL LIMIT/V PHASE/RETURN)
EXIT JUMP	









SETUP

PC CONTROL	CAM ID : 1 ~ 255 PROTOCOL : PELCO-D BAUDRATE : 2400 / 4800 / 9600 / 19200 RETURN
TITLE	OFF / ON.. (TITLE/ID POSITION(UP-LEFT/UP-CENTER/UP-RIGHT/DOWN-LEFT/DOWN-CENTER/DOWN-RIGHT))
LANGUAGE	ENGLISH
OMNI LENS	OFF ON.. ALARM OFF ALARM ON (READ TIME(5~15)/ALARM ZOOM(4~214)/STAND BY(0~214)/RETURN)
FLUORESCENT	OFF / CRR(Manual Lens,Color Rolling/Flickerless Mode)/CRR2 (DC Lens, Color Rolling Mode)
DIGITAL VIDEO OUTPUT	DIGITAL OUT : OFF / ON FIELD ORDER : NORMAL / REVERSE FRAME RPT : OFF / 2x / FREEZE RETURN
EXIT JUMP	

EXIT

EXIT	
SAVE & EXIT	
FACTORY SET	

B1367WD, 1367WTIR, B1367WTIR650, B2382TIR

EXPOSURE		COLOR		DAY&NIGHT	
	<ul style="list-style-type: none"> — BRIGHTNESS — E. SHUTTER — BLC — MAX_DR — AGC — STARLIGHT 		<ul style="list-style-type: none"> — WB MODE — R-Y GAIN — B-Y GAIN 		<ul style="list-style-type: none"> — D&N MODE — C-SUP — A-SUP
FUNCTION		MOTION		PRIVACY	
	<ul style="list-style-type: none"> — MIRROR — SHARPNESS — GAMMA — FREEZE — NEGA. — 3D DNR — D-ZOOM — SLC — HME — DIS 		<ul style="list-style-type: none"> — MOTION 		<ul style="list-style-type: none"> — MASK 1 — MASK 2 — MASK 3 — MASK 4 — MASK 5 — MASK 6
SYNC		SETUP		EXIT	
	<ul style="list-style-type: none"> — SYNC MODE 		<ul style="list-style-type: none"> — CAMERA ID — TITLE — DPC — MONITOR — LANGUAGE — BAUDRATE — OMNI LENS 		<ul style="list-style-type: none"> — EXIT — SAVE & EXIT — FACTORY SET

EXPOSURE

BRIGHTNESS	0 ~ 99
E.SHUTTER	1/60 / 1/100 / FLC / 1/250 ~ 100000 / SENS-UP x2 ~ x256
BLC	OFF / ON BLC (Back Light Compensation)
MAX_DR	OFF / ON (0~20) (Electronic Wide Dynamic Range)
AGC	HIGH / MIDDLE / LOW / OFF AGC (AUTO GAIN CONTROL)
STARLIGHT	AUTO (x2 ~ x256) / OFF (~x256)
EXIT JUMP	EXIT / SAVE&EXIT / FACTORY SET

COLOR

WB MODE	AWC / ATW / MANUAL / PUSH
R-Y GAIN	0 ~ 255
B-Y GAIN	0 ~ 255
EXIT JUMP	EXIT / SAVE&EXIT / FACTORY SET

DAY & NIGHT

D & N Mode	AUTO / COLOR / BW COLOR → BW : Switching from COLOR to BW; If the number is higher, the camera will only switch during a super low light condition. BW → COLOR : Switching from BW to COLOR; This number should be always lower than COLOR to BW Read Time : time interval to switch from COLOR to BW COLOR B&W : (BURST : OFF/ON) When the burst is OFF, the picture will have less noise.
C_SUP	Color Suppression : Color will be reduced at low illumination, if the C_SUP Level is higher. 0 ~ 100 (not available when 3D-DNR is on)
A_SUP	Aperture Suppression : Edge sharpness will be reduced at low illumination, if A_SUP Level is higher. 0 ~ 100 (not available when 3D-DNR is on)
EXIT JUMP	EXIT / SAVE&EXIT / FACTORY SET

FUNCTION

MIRROR	OFF / MIRROR / V-FLIP / ROTATE
SHARPNESS	0 ~ 49
GAMMA	0.45 ~ 1.00 / USER
FREEZE	OFF / ON
NEGA.	OFF / ON
3D DNR	OFF / LOW / MIDDLE / HIGH 3D DNR (3D Digital Noise Reduction)
D-ZOOM	OFF / ON(x1.0 ~ x3.0 Digital PTZ)
SLC	OFF / ON SLC (Side Light Compensation)
HME	OFF / ON HME (Highlight Masking Exposure)
DIS	OFF / ON DIS (Digital Image Stabilizer)
EXIT JUMP	EXIT / SAVE&EXIT / FACTORY SET

MOTION

MOTION	OFF / ON
	SET WINDOW
	ALL SET (Set the Entire Screen)
	ALL CLEAR (Clear the Entire Screen)
	SENSITI. (1 ~ 120)
	SHOW INDI. (OFF / ICON / TRACE)
EXIT JUMP	DELAY OUT(1 ~ 15) Motion Alarm Zoom-In Delay
	EXIT / SAVE&EXIT / FACTORY SET

PRIVACY

MASK 1	OFF / ON ↗
MASK 2	OFF / ON ↗
MASK 3	OFF / ON ↗
MASK 4	OFF / ON ↗
MASK 5	OFF / ON ↗
MASK 6	OFF / ON ↗
EXIT JUMP	EXIT / SAVE&EXIT / FACTORY SET

SYNC

SYNC MODE	INTER. / AUTO
V_PHASE	0 ~ 199
EXIT JUMP	EXIT / SAVE&EXIT / FACTORY SET

SETUP

CAMERA ID	0 ~ 254 (RS485 ID)
TITLE	OFF / ON
DPC	OFF / AUTO DPC (Dead Pixel Cancellation)
MONITOR	CRT / LCD (Select LCD only if the camera is directly connected to LCD monitor.)
LANGUAGE	English / Chinese
BAUDRATE	2400 / 4800 / 9600 / 14400 / 19200 / 38400 The protocol is Pelco-D. Fixed and cannot be changed.(Hardcoded onto the DSP.)
OMNI LENS	OFF / 0 (OMNI-Plus Camera Only)
EXIT JUMP	EXIT / SAVE&EXIT / FACTORY SET

EXIT

EXIT	Exit the menu
SAVE & EXIT	Exit the menu and save the setting
FACTORY SET	Reset the menu setting to factory default

SPECIFICATION*

MODEL	DWC-B1362TIR650	
General Spec	NTSC	PAL
CCD Type	1/3" 410K Pixels Color	1/3" 470K Pixels Color
Total number of pixels	811(H) X 508 (V)	795(H) X 596(V)
Minimum Illumination	0.1Lux (F1.2, 30IRE-COLOR)	
	0.0Lux (LED ON)	
Resolution	540 TV Lines (COLOR)	
	580 TV Lines (BW)	
Electric Spec		
Voltage	DC 12[V] (11.0[V] ~ 20.0[V])	
	AC 24[V] (20.0[V] ~ 30.0[V])	
Power Consumption	LED OFF(DC12V:3.8W / AC24V:4.2W)	
	LED ON(DC12V:6.6W / AC24V:7.1W)	
COMMON		
General Spec	NTSC	PAL
Shutter speed	1/60s - 1/100,000s	1/50s - 1/100,000s
S/N Ratio	50dB or More(AGC OFF)	
Gamma	0.45	
Sync System	Internal / Line Lock	
Mechanical Spec		
Operation Temperature	-10℃ ~ +50℃ (14°F ~ 131°F)	
Storage Temperature	-20℃ ~ +70℃	
Operation Humidity	Under 90% (Non-condensing)	

MODEL		
DWC-B1363D, B1363TIR		
General Spec	NTSC	PAL
CCD Type	1/3" 410K Pixels Color	1/3" 470K Pixels Color
Total number of pixels	811(H) X 508 (V)	795(H) X 596(V)
Minimum Illumination	0.14Lux (F1.2, 30IRE-COLOR)	
	0Lux (LED ON)	
Resolution	560 TV Lines (COLOR)	
	580 TV Lines (BW)	
Electric Spec		
Voltage	DC 12[V] (11.0[V] ~ 20.0[V])	
	AC 24[V] (20.0[V] ~ 30.0[V])	
Power Consumption	LED OFF(DC12V:3.8W / AC24V:4.2W)	
	LED ON(DC12V:6.9W / AC24V:7.2W)	
COMMON		
General Spec	NTSC	PAL
Shutter speed	1/60s - 1/100,000s	1/50s - 1/100,000s
S/N Ratio	52dB or More(AGC OFF)	
Gamma	0.45	
Sync System	Internal / Line Lock	
Mechanical Spec		
Operation Temperature	-10℃ ~ +50℃ (14°F ~ 131°F)	
Storage Temperature	-20℃ ~ +70℃	
Operation Humidity	Under 90% (Non-condensing)	

MODEL	DWC-B1365T	
General Spec	NTSC	PAL
CCD Type	1/3" 410K Pixels Color	
Total number of pixels	768(H) X 548 (V)	
Minimum Illumination	0.22Lux (F1.2, 30IRE-COLOR)	
	0.0Lux (LED ON)	
Resolution	690 TV Lines Effective	
	(H: 540 TV Lines / V:460 TV Lines)	
Electric Spec		
Voltage	DC 12[V] (11.0[V] ~ 20.0[V])	
	AC 24[V] (20.0[V] ~ 30.0[V])	
Power Consumption	(DC12V:3.9W / AC24V:4.2W)	
COMMON		
General Spec	NTSC	PAL
Shutter speed	1/25s - 1/30,720s	
S/N Ratio	53dB or More(AGC OFF)	
Gamma	0.45	
Sync System	Internal / Line Lock	
Mechanical Spec		
Operation Temperature	-10℃ ~ +50℃ (14°F ~ 131°F)	
Storage Temperature	-20℃ ~ +70℃	
Operation Humidity	Under 90% (Non-condensing)	

MODEL	DWC-B1367WD,B1367WTIR,B1367WTIR650,B2382TIR	
General Spec	NTSC	PAL
CCD Type	1/3" 410K Pixels Color	1/3" 470K Pixels Color
Total number of pixels	811(H) X 508(V)	795(H) X 596(V)
Minimum Illumination	0.14Lux (F1.2, 30IRE-COLOR) 0.0Lux (LED ON)	
Resolution	580 TV Lines (COLOR) 600 TV Lines (BW)	
Electric Spec		
Voltage	DC 12[V] (11.0[V] ~ 20.0[V]) AC 24[V] (20.0[V] ~ 30.0[V])	
Power Consumption	OFF (DC12V: 3.3W / AC24V: 3.8W) 38IR LED ON (DC12V: 6.0W / AC24V: 6.5W) 42IR LED ON (DC12V: 6.6W / AC24V: 7.1W)	
COMMON		
General Spec	NTSC	PAL
Shutter speed	1/60s - 1/100,000s	1/50s - 1/100,000s
S/N Ratio	50dB or More(AGC OFF)	
Gamma	0.45	
Sync System	Internal / Line Lock	
Mechanical Spec		
Operation Temperature	-10℃ ~ +50℃ (14°F ~ 131°F)	
Storage Temperature	-20℃ ~ +70℃	
Operation Humidity	Under 90% (Non-condensing)	

REMOTE CONTROL*

Menu Accessand Control

Zoom Function Control

Key Button

ID Buttons



Motion Alarm
ON&OFF

<Remote Control Picture>

DWC-B2382TIR

■ REMOTE CONTROL Instructions ;

- 1) Set the camera ID in OSD menu.(The default setting is "001")
NOTE : If the camera ID is modified, the new camera ID must be set, and the power must be turned ON and OFF. Then the camera is able to recognize the new ID.
- 2) Press the "KEY" and the camera turns into the standby image. The LED flickers for 20 seconds.
- 3) Input ID number of CAMERA to Remote Controller ID number. After you input the ID number, LED light is turned on, and the remote controller is ready to set the camera.
NOTE : The ID number must be 3-digit.
- 4) ZOOM IN (+) / ZOOM IN (-) key
These are for controlling lens zoom, and selecting the zooming area of Alarm function.
- 5) Select the desired area where you wish to observe the movement of objects. And then select the zooming range by pressing "7" wide key.
- 6) Please save alarm generating zooming range by "8" tele key. If ALARM generating zoom range is smaller than ALARM standby range, ALARM Zoom range setting will not be saved.
- 7) If select "9" ON/OFF key, product operates automatically from tele to wide 1 time. And then the alarm function starts.
- 8) Please press "9" key for cancel the alarm function or to reselect the alarm zooming area.

NOTE :

Press [KEY] + [ID] (Default is "001" for ID=1)

Press [ENT] to access the Menu

Note : The camera ID is a 3-digit number.

WARRANTY INFORMATION*

Digital Watchdog (referred to as "the Warrantor") warrants the Digital Watchdog Camera against defects in materials or workmanship as follows:

LABOR : For the initial five (5) years and one (1) year on IR LED from the original purchase date, if the camera is determined to be defective, the Warrantor will repair or replace the unit with a new or refurbished product at its option at no charge.

PARTS : In addition, the Warrantor will supply replacement parts for the initial five (5) years and one (1) year on IR LED.

To obtain warranty or out of warranty service, please contact a Technical Support Representative at **1-866-446-3595** Monday through Friday from 8:30AM to 8:00PM Eastern Standard Time.

A purchase receipt or other proof of the original purchase date is required before warranty service is rendered. This warranty only covers failures due to defects in materials and workmanship which arise during normal use. This warranty does not cover damage which occurs in shipment or failures which are caused by products not supplied by the Warrantor or failures which result from accident, misuse, abuse, neglect, mishandling, misapplication, alteration, modification, faulty installation, set-up adjustments, improper antenna, inadequate signal pickup, maladjustment of consumer controls, improper operation, power line surge, improper voltage supply, lightning damage, rental use of the product or service by anyone other than an authorized repair facility or damage that is attributable to acts of God.

LIMITS AND EXCLUSIONS*

There are no express warranties except as listed above. The Warrantor will not be liable for incidental or consequential damages (including without limitation or damage to recording media), resulting from the use of these products or arising out of any breach of the warranty. All express and implied warranties, including the warranties of merchantability and fitness for particular purpose, are limited to the applicable warranty period set forth above.

Some states do not allow the exclusion or limitation of incidental or consequential damages, or limitations on how long an implied warranty lasts, so the exclusions or limitations listed above may not apply to you. This warranty gives you specific legal rights, and you may also have other rights that vary from state to state.

If the problem is not handled to your satisfaction, then write to the Address listed on the next page.

Service calls which do not involve defective materials or workmanship as determined by the Warrantor, in its sole discretion, are not covered. Costs of such service calls are the responsibility of the purchaser.



5436 W Crenshaw St. Tampa, FL 33634

Tel : 866-446-3595 / 813-888-9555

Fax : 813-888-9262

www.Digital-Watchdog.com

technicalsupport@dwcc.tv

Technical Support Hours : Monday-Friday

8:30am to 8:00pm Eastern Time