

# BULLET CAMERA, WEATHER RESISTANT, NO FOG NO CONDENSATION DESIGN, IR LED, DAY AND NIGHT

Small Commercial, Residential, Transportation,  
Education, Retail and C-Store



**B3252DIR/Bullet Camera, Fixed Lens, IR LED, Electronic Day and Night, NEMA IP66**

High quality and attractive style is what makes the B3252DIR Bullet Camera the perfect solution for many cost sensitive applications. The unit's compact size along with its unique mounting bracket makes installation as simple as possible. This model offers a Wide Angle Fixed Lens for general viewing applications, and our 1/3" Sony Super HAD CCD chip set offers sharp, clear images, which is why it is an easy choice for small security applications. When selecting a High Quality Weather Resistant Bullet Camera that must meet a value to cost ratio, choose the Digital Watchdog Camera series. Each model includes a power supply and a 5 Year Warranty.



[www.digital-watchdog.com](http://www.digital-watchdog.com)



## Dimensions

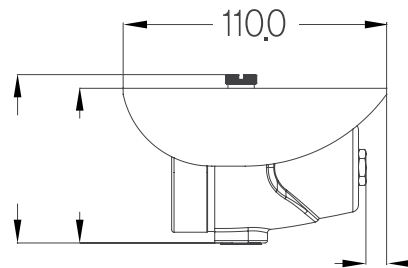

## Summary

High quality and attractive style is what makes the B3252DIR the perfect solution for many cost sensitive applications. Its compact size and unique mounting bracket makes installation as easy as possible. This model offers a 3.6mm fixed lens for general viewing applications, and our 1/3" Samsung CCD chip offers sharp, clear images, which is why it is a great choice for small security applications. Each model includes a power supply and a five year warranty.

## Features

- 1/3" Samsung CCD
- 420 TV Lines
- 3.6mm Fixed Lens
- 35ft Range IR with Intelligent Camera Sync
- AWB (Auto White Balance)
- Clear Image
- Wide Operating Voltage (8VDC-18VDC)
- Low Power Consumption
- Weatherproof Design
- Removable Sunshield
- CE, FCC, RoHS Certified
- Small and Compact Size for Most Applications
- Affordable for Simple Security Applications
- 12VDC Transformer Included
- 5 Year Limited Warranty

## Specifications

Model	DWC-B3252DIR
Image Sensor	1/3" Samsung CCD
Pixels-Total	537 (H) x 505 (V)
Pixels-Effective	510 (H) x 492 (V)
Scanning System	525 Line, 2:1 Interlace
Minimum Illumination	0.0 Lux (LED ON)
Horizontal Resolution	420 TV Lines
Focal Length	3.6mm Fixed
Power Requirement	DC 12V
Power Consumption	DC12V: 0.9W, 75mA
	DC12V: 2.92W, 243mA
Video Output	VBS 1.0Vp-p (75 Load)
S/N Ratio	48dB
Dimensions	110 x 64.7 mm (4.33 x 2.55 in)
Weight	0.4 lbs
Operation Temperature	-29°C ~ +55 °C (-20°F ~ 131 °F)
Storage Temperature	-20°C ~ +70 °C (-4 °F ~ 158 °F)
Operation Humidity	Less than 90%

(\*) Specification is subject to change without prior notice.

