

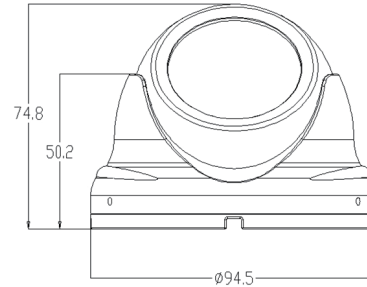

Dimensions (Unit : mm)



Summary

The BL352IRW is the perfect choice for simple security applications. It is affordable yet equipped. The BL352IRW is a vandal and weather-resistant 3-axis ball camera that offers a wide angle fixed lens for general viewing applications and a 1/3" CCD chipset for sharp and clear images. It promises excellent color sensitivity and high resolution for both day and night applications, and its compact size and simple mounting device also makes installation quick and easy. This ball camera was designed to satisfy your cost-sensitive security purposes.

Features

- 1/3" CCD
- 540 TV Line
- 3.6mm Fixed Lens
- 18 ~ 20ft Range IR
- Low Power Consumption
- Wide Operating Voltage (8VDC~18VDC)
- Ultra Low Light Sensitivity
- Auto BLC (Automatic Backlight Compensation)
- IP66 Certified
- 3-Axis Ball Neck Bracket (Simple Camera Positioning)
- White Color Housing
- 2 Year Warranty

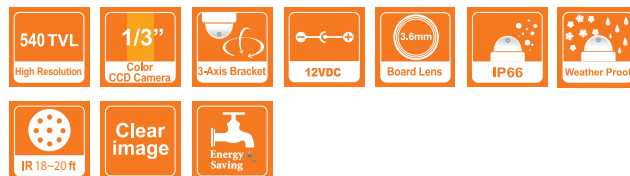

Specifications

Model		BL352IRW
Camera Type	Color/BW	12IR-ED Day/Night Digital Dome Camera
Image	Sensor	1/3" CCD
	Pixels-Total	811(H) x 508(V); 411K Pixels
	Pixels-Effective	768(H) x 494(V)
Scanning	System	525 Line, 2:1Interlace
	Horizontal Frequency Internal Mode	15,734 Hz (NTSC)
	Vertical Frequency Internal Mode	59.94 Hz (NTSC)
Min. Scene Illumination	IR-LED on	Zero Lux
Lens	Focal Length	3.6mm Fixed Lens
Resolution	Horizontal	540 TV Lines
Video Output	VBS 1.0Vp-p	VBS 1.0Vp-p (75 Load)
S/N Ratio	S/N Ratio	50dB
Environmental Conditions	Operating Temperature	-10 ~ +55 (14 ~ 131)
	Humidity	Less then 90%
Power	Power Requirement	12VDC
	Power Consumption	LED OFF : 1W, 83.3mA LED ON : 2.2W, 183.3mA
Physical Specification	Color	White
	Dimensions	74.8X 94.5mm, 2.94X3.72in
	Weight	0.8818 lbs
	Nema Type	IP66

(*) Specification is subject to change without prior notice.