



5436 W Crenshaw St. Tampa, FL 33634  
Tel: 866-446-3595 / 813-888-9555  
Fax: 813-888-9262  
[www.Digital-Watchdog.com](http://www.Digital-Watchdog.com)  
[technicalsupport@dwcc.tv](mailto:technicalsupport@dwcc.tv)  
Technical Support Hours: Monday-Friday  
8:30am to 8:00pm Eastern Time

# **D2362DIR, D2363D, D2363TIR D2367WD, D2367WTIR D2382TIR, D2365T Indoor Dome Camera**

## **User Manual**



### **ABOUT MANUAL**

Before installing and using the camera, please read this manual carefully.  
Be sure to keep it handy for future reference.

## PRECAUTIONS

---

- Do not open or modify.
- Do not open the case except during maintenance and installation, for it may be dangerous and can cause damages.
- Do not put objects into the unit.
- Keep metal objects and flammable substances from entering the camera. It can cause fire, short-circuits, or other damages.
- Be careful when handling the unit.
- To prevent damages, do not drop the camera or subject it to shock or vibration.
- Do not install near electric or magnetic fields.
- Protect from humidity and dust.
- Protect from high temperature.
- Be careful when installing near the ceiling of a kitchen or a boiler room, as the temperature may rise to high levels.
- Cleaning
  - To remove dirt from the case, moisten a soft cloth with a soft detergent solution and wipe.
- Mounting Surface
  - The material of the mounting surface must be strong enough to support the camera.

## FCC COMPLIANCE

---

This equipment has been tested and found to comply with the limits for a Class B digital device, pursuant to Part 15 of the FCC rules. These limits are designed to provide reasonable protection against harmful interference when the equipment is operated in a residential environment. This equipment generates, uses, and radiates radio frequency energy; and if it is not installed and used in accordance with the instruction manual, it may cause harmful interference to radio communications.

**WARNING :** Changes or modifications are not expressly approved by the manufacturer.

## TROUBLESHOOTING

---

Before sending your camera for repair, check the following or contact our technical specialist.

### No VIDEO

Check the coaxial cable and make sure it is connected securely.

Check the lens' iris adjustment at the menu setup of the camera.

Check the power supply and make sure the camera has the proper voltage and current.

### Out-of-Focus VIDEO

Check the clear dome cover and the lens for dirt or fingerprints. Use a soft cloth and gently clean.

Check the lens manual focal and zoom adjustment. Field test monitor is recommended.

## FEATURES\*-D2362DIR

- 1/3" High Resolution CCD
- 540 TV Lines
- 3.3 ~ 12mm Varifocal Auto Iris Lens
- 100ft Range IR with Intelligent Camera Sync
- Electronic Day and Night
- DRC (Dynamic Range Compressor)
- HME (Highlight Masking Exposure)
- SLC (Side Light Compensation)
- AGC / BLC / AWB
- Negative Imaging
- Mirror Image Control
- RS485 Built-In
- Programmable Privacy Zone (4) & Motion Detection
- Easy Icon Driven OSD Menu with Built-In Joystick
- Secondary Video-BNC Output

## FEATURES\*-D2363D

- 1/3" High Resolution CCD
- High Resolution 560 TV Lines
- 3.3 ~ 12mm Varifocal Auto Iris Lens
- Electronic Day and Night
- Star-Light (Super Low Light Technology)
- DRC (Dynamic Range Compressor)
- 3D-DNR (3D Digital Noise Reduction)
- HME (Highlight Masking Exposure)
- Negative Imaging
- AGC / BLC / AWB
- Programmable Privacy Zone (6) & Motion Detection
- Easy Icon Driven OSD Menu with Built-In Joystick
- Auto Sensing 12VDC or 24VAC with Line Lock
- Secondary Video-BNC Output

## FEATURES\*-D2363TIR

- 1/3" High Resolution CCD
- High Resolution 560 TV Lines
- 3.3 ~ 12mm Varifocal Auto Iris Lens
- Electronic Day and Night
- 100ft Range IR with Intelligent Camera Sync
- True Day and Night / TDN5
- Star-Light (Super Low Light Technology)
- DRC (Dynamic Range Compressor)
- 3D-DNR (3D Digital Noise Reduction)
- HME (Highlight Masking Exposure)
- Negative Imaging
- AGC / BLC / AWB
- Programmable Privacy Zone (6) & Motion Detection
- Easy Icon Driven OSD Menu with Built-In Joystick
- Auto Sensing 12VDC or 24VAC with Line Lock
- Secondary Video-BNC Output

## FEATURES\*-D2367WD

- 1/3" Sony Super HAD II CCD
- 560 TV Lines
- 3.3 ~ 12mm Varifocal Auto Iris Lens
- Electronic Day and Night
- EWDR (Electronic Wide Dynamic Range)
- Star-Light (Super Low Light Technology)
- DSS (Digital Slow Shutter)
- 3D-DNR (3D Digital Noise Reduction)
- DIS (Digital Image Stabilizer)
- HME (Highlight Masking Exposure)
- AGC / BLC / AWB
- Programmable Privacy Zone (6) & Motion Detection
- Easy Icon Driven OSD Menu with Built-in Joystick
- Auto Sensing 12VDC/24VAC with Line Lock
- Secondary Video-BNC Output

## FEATURES\*-D2367WTIR

- 1/3" Sony Super HAD II CCD
- 560 TV Lines
- 3.3 ~ 12mm Varifocal Auto Iris Lens
- 100ft Range IR with Intelligent Camera Sync
- True Day and Night / TDN5
- EWDR (Electronic Wide Dynamic Range)
- Star-Light (Super Low Light Technology)
- DSS (Digital Slow Shutter)
- 3D-DNR (3D Digital Noise Reduction)
- DIS (Digital Image Stabilizer)
- HME (Highlight Masking Exposure)
- AGC / BLC / AWB
- Programmable Privacy Zone (6) & Motion Detection
- Easy Icon Driven OSD Menu with Built-in Joystick
- Auto Sensing 12VDC/24VAC with Line Lock
- Secondary Video-BNC Output

## FEATURES\*-D2382TIR

- 1/3" Sony Super HAD II CCD
- High Resolution 560TV Lines
- OMNI-Focus 2.9~8.5mm 3X Motorized Zoom, Auto Iris 70ft Range IR with Intelligent Camera Sync
- True Day & Night / TDN5 (Electro Magnetic Mechanism)
- Max-DR (Electronic Wide Dynamic Range)  
Enables the camera to capture perfect images in both bright and dark environments simultaneously.
- 3D-DNR (3D Digital Noise Reduction)  
Produces less noise and more color during low-light application.
- HME (Highlight Mask Exposure)  
Masks overly exposed light to produce a true video image of any environment.
- SLC (Side Light Compensation)
- DIS (Digital Image Stabilizer)
- Programmable Privacy Zone (6) & Motion Detection Easy Icon Driven OSD Menu with Built-In Joystick
- Auto Sensing 12VDC or 24VAC with Line Lock
- No Fog or Condensation under Any Weather Condition

## FEATURES\*-D2365T

- 1/3" Pixim Seawolf CMOS Sensor
- 690 Horizontal TV Lines
- 3.3 ~ 12mm Varifocal Auto Iris Lens
- TDN (True Day and Night/IR Cut Filter)
- 3D-DNR (3D Digital Noise Reduction)
- Powerful Wide Dynamic Range
- Smear Canceling Circuit
- AGC / BLC / AWB
- DIS (Digital Image Stabilizer)
- HME (Highlight Masking Exposure)
- AGC / BLC / AWB
- Programmable Privacy Zone (6) & Motion Detection
- Easy Icon Driven OSD Menu with Built-in Joystick
- Low Power Consumption
- Auto Sensing 24VAC/12VDC with Line Lock
- Secondary Video-BNC Output

## DIMENSION (mm)\*

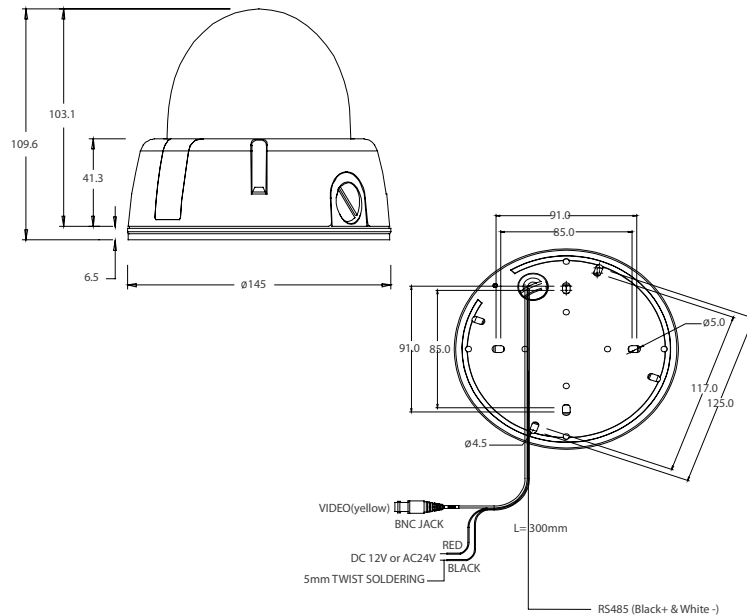

## Power Requirement \*

Power Wire Maximum Distance		
Wire Gauge	12VDC	24VAC
24 AWG	80feet	323feet
22 AWG	128feet	513feet
20 AWG	203feet	815feet
18 AWG	323feet	1295feet
16 AWG	514feet	2056feet
14 AWG	816feet	3264feet
12 AWG	1295feet	5183feet
10 AWG	2057feet	8228feet

### Coaxial Cable Type Maximum Distance

RG59/U	750feet
RG6/U	1,000feet
RG11/U	1,500feet

### Power Requirement

12VDC at 1A
24VAC at 500mA

## INSTALLATION\*

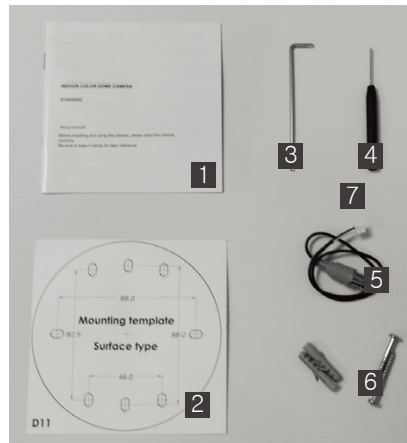

### Included with Digital Watchdog Camera:

1. User Manual
2. Mounting Template
3. Security L-Key
4. Single Sided Hex Key
5. Secondary BNC Cable for a Field Monitor
6. Four (4) Screws and Four (4) Dry Wall Anchors

### Camera Installation

Use the Mounting Template when mounting the camera.

Use the Security L-Key to loosen the Four Screws that secure the vandal-proof dome cover. Remove the cover; then, remove the inner screw holes to mount the camera.

**NOTE:** Keep the lens and the vandal proof cover free from dust or fingerprint.

## INSTALLATION AND ADJUSTMENT\*-D2382TIR

### Included with DW Indoor Dome Camera:

1. User Manual
2. Mounting Template
3. One Security L-Key
4. One Single Sided Hex Key
5. Secondary BNC Cable for a Field Monitor
6. Two (2) Screws and Two (2) Dry Wall Anchors
7. IR Remote Controller

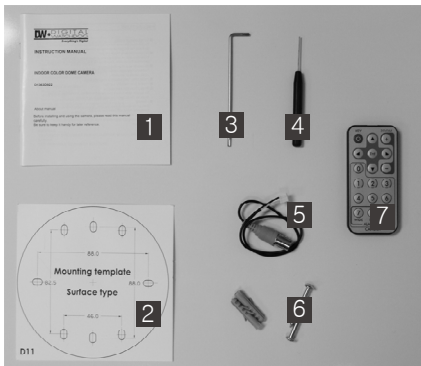

### Camera Installation

Use the mounting template to mount the camera. Using the security L-key to loosen the four screws that secure the vandal proof dome cover, Remove the vandal proof dome cover to access the screw holes to mount the camera.

**NOTE:** Keep the lens and the vandal proof cover free from dust or fingerprint.

### 3-Axis Gimbal Adjustment



## INSTALLATION\*

- A. Loosen the Screws (A) with the Security L-Key included with your camera.
- B. Separate the Upper Case (B) from the Base (F).
- C. Cut a hole in the ceiling for routing the cables.
- D. Use the Mounting Template to drill the four screw holes on the surface of the ceiling.
- E. Pass the Power Cable (C) and the Video Cable (E) from the camera unit through the hole in the ceiling.
- F. Align the screw holes of the camera unit with the holes in the ceiling. Secure the four screws.
- G. Install and adjust the camera unit.
- H. Assemble the Upper Case (B) and the Base (F).
- I. Put the upper case and the base together.
- J. Tighten the outer Screws (A) using the Security L-Key.

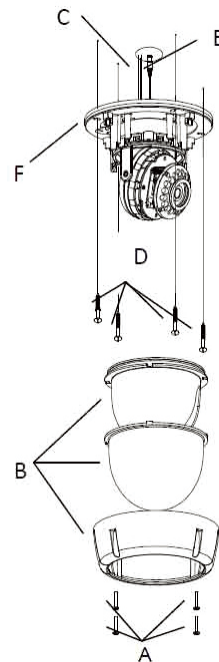



## CONNECTION\*

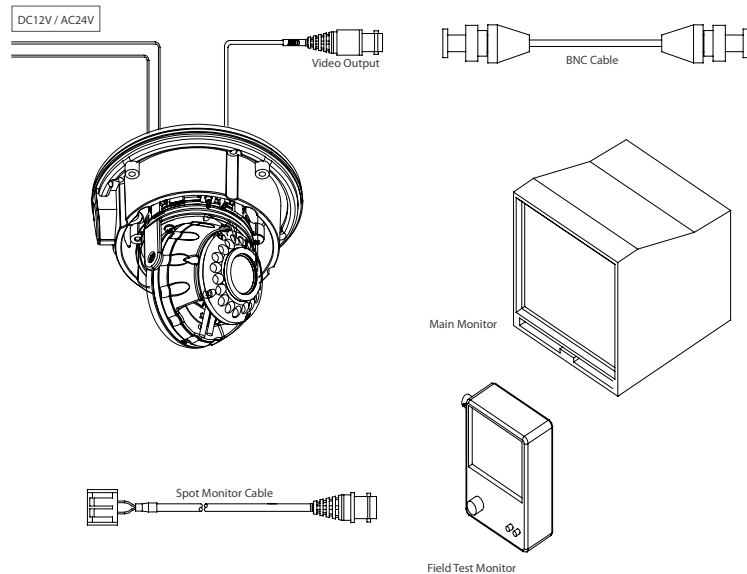

## CAMERA OSD & IR REMOTE CONTROLLER\*

-D2382TIR

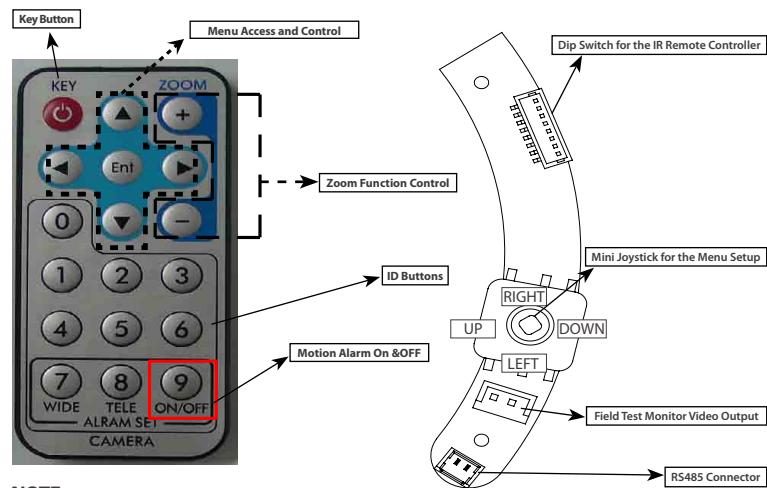

### NOTE:

Press [KEY] + [ID] (Default is "001" for ID=1)

Press [ENT] to access the Menu

Note: The camera ID is a 3-digit number.

## LENS ADJUSTMENT\*









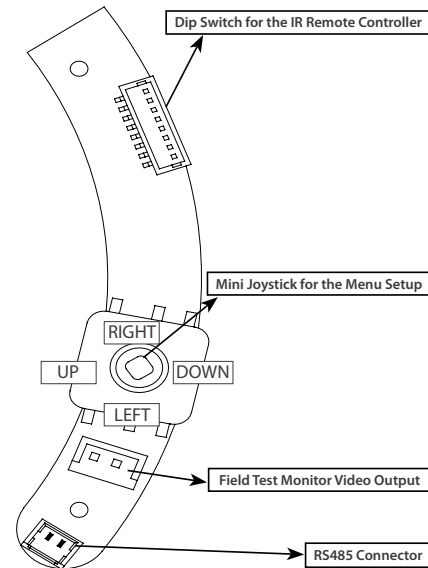

- A. Move the Zoom Lever until you get the desired position.
- B. Move the Focus Lever until you get the desired focus.

## CAMERA SETTING & ON-SCREEN DISPLAY\*

: D2362DIR, D2363D, D2363TIR, D2367WD, D2367WTIR, D2382TIR, D2365T



## MODULE OSD MENU\* -D2362DIR

EXPOSURE	COLOR	DAY&NIGHT
 <ul style="list-style-type: none"> <li>BRIGHTNESS</li> <li>SHUTTER</li> <li>BLC</li> <li>AGC</li> </ul>	 <ul style="list-style-type: none"> <li>WB MODE</li> </ul>	 <ul style="list-style-type: none"> <li>D&amp;N MODE</li> </ul>
FUNCTION	MOTION	PRIVACY
 <ul style="list-style-type: none"> <li>MIRROR</li> <li>SHARPNESS</li> <li>GAMMA</li> <li>SLC</li> <li>HME</li> <li>DRC</li> </ul>	 <ul style="list-style-type: none"> <li>ALARM</li> </ul>	 <ul style="list-style-type: none"> <li>MASK 1</li> <li>MASK 2</li> <li>MASK 3</li> <li>MASK 4</li> <li>COLOR SET</li> </ul>
SYNC	SETUP	EXIT
 <ul style="list-style-type: none"> <li>SYNC</li> </ul>	 <ul style="list-style-type: none"> <li>CAMERA ID</li> <li>TITLE EDIT</li> <li>TITLE RESET</li> <li>TITLE POSITION</li> <li>DPC SET</li> <li>LANGUAGE</li> <li>PC CONT.</li> </ul>	 <ul style="list-style-type: none"> <li>EXIT</li> <li>SAVE &amp; EXIT</li> <li>FACTORY RESET</li> </ul>









## OSD MENU\* -D2362DIR

EXPOSURE	
BRIGHTNESS	MANUAL (ELC LEVEL : 0 ~ 100) / DC (DC LEVEL : 0 ~ 31)
SHUTTER	1/60, 1/100FLC, 1/120 ~ 1/100000
BLC	OFF / ON BLC (Back Light Compensation)
AGC	OFF / 12dB ~ 36dB AGC (Auto Gain Control)
COLOR	
WB MODE	AWC / ATW / MANuAL / PUSHLOCK AWC is recommended.
R-Y GAIN	0 ~ 255
B-Y GAIN	0 ~ 255
DAY & NIGHT	
Day & Night Mode	<b>AUTO / COLOR / BW</b>
	<b>COLOR----&gt;BW</b> : Switching from COLOR to BW; If the number is higher, the camera will only switch during a super low light condition.
	<b>BW ----&gt;COLOR</b> : Switching from BW to COLOR; This number should be always lower than COLOR to BW
	<b>Read Time</b> : time interval to switch from COLOR to BW
	COLOR
B&W Mode : (BURST : OFF/ON) When the burst is OFF, the picture will have less noise.	

FUNCTION	
MIRROR	OFF / MIRROR
SHARPNESS	0 ~ 49
GAMMA	USER / 0.45 / 0.6 / 1.00
SLC	OFF / ON (0 ~ 50) SLC (Side Light Compensation)
HME	OFF / ON (0 ~ 55) HME (Highlight Masking Exposure)
DIS	OFF / ON DIS (Digital Image Stabilizer)
MOTION (OMNI-Plus Cameras Only)	
MOTION	OFF / ON
	SET WINDOW
	ALL SET (Set the Entire Screen)
	ALL CLEAR (Clear the Entire Screen)
	SENSITIVITY (0 ~ 55)
	SHOW INDICATOR (OFF / ICON / TRACE)
	DELAY OUT(1 ~ 15) Motion Alarm Zoom-In Delay

PRIVACY	
MASK 1	OFF / ON ↵
MASK 2	OFF / ON ↵
MASK 3	OFF / ON ↵
MASK 4	OFF / ON ↵
COLOR SET	BLACK / GRAY / COLOR 1~ 6
SYNC	
SYNC MODE	INTERNAL / AUTO
V-PHASE	0 ~ 199
SETUP	
CAMERA ID	0 ~ 255
TITLE EDIT	
TITLE RESET	
TITLE POS.	
DPC	OFF / ON DPC ( Dead Pixel Cancellation)
LANGUAGE	English / Chinese
PC CONT.	OFF / ON
EXIT	
EXIT	Exit the menu
SAVE&EXIT	Exit the menu and save the setting
FACTORY SET	Reset the menu setting to factory default

## MODUEL OSD MENU\* -D2363D, D2363TIR

EXPOSURE	COLOR	DAY&NIGHT
 <ul style="list-style-type: none"> <li>BRIGHTNESS</li> <li>AE PREFERENCE</li> <li>BLC / HME</li> <li>AGC</li> <li>STARLIGHT</li> <li>NIGHT-UP</li> </ul>	 <ul style="list-style-type: none"> <li>WB MODE</li> <li>R-Y GAIN</li> <li>B-Y GAIN</li> </ul>	 <ul style="list-style-type: none"> <li>D&amp;N MODE</li> <li>C_SUP</li> <li>A_SUP</li> </ul>
FUNCTION	MOTION	PRIVACY
 <ul style="list-style-type: none"> <li>MIRROR</li> <li>SHARPNESS</li> <li>GAMMA</li> <li>FREEZE</li> <li>NEGATIVE</li> <li>D-ZOOM</li> <li>3D DNR</li> <li>DRC</li> </ul>	 <ul style="list-style-type: none"> <li>MOTION</li> </ul>	 <ul style="list-style-type: none"> <li>PRIVACY</li> </ul>
SYNC	SETUP	EXIT
 <ul style="list-style-type: none"> <li>— SYNC</li> </ul>	 <ul style="list-style-type: none"> <li>TITLE EDIT</li> <li>PC CONTROL (RS485 Control)</li> <li>LANGUAGE</li> <li>MONITOR</li> <li>OSD COLOR</li> <li>OMNI LENS</li> <li>DEFECT</li> </ul>	 <ul style="list-style-type: none"> <li>EXIT</li> <li>SAVE &amp; EXIT</li> <li>FACTORY RESET</li> </ul>









## OSD MENU\* -D2363D, D2363TIR

EXPOSURE	
BRIGHTNESS	0 ~ 100
SHUTTER	1/60 / FLK / 1/250 ~ 10000 / SENS-UP x2 ~ x256
BLC/HME	OFF / BLC / HME
AGC	HIGH / MIDDLE / LOW / OFF <b>AGC(Auto Gain Control)</b>
STARLIGHT	AUTO(x2 ~ x256) / OFF
NIGHT-UP	NORMAL / HIGH
EXIT JUMP	EXIT / SAVE&EXIT / FACTORY SET
COLOR	
WB MODE	AWC / AWT / PUSH LOCK / MANUAL / INDOOR / OUTDOOR
R-Y GAIN	0 ~ 100
B-Y GAIN	0 ~ 100
EXIT JUMP	EXIT / SAVE&EXIT / FACTORY SET
DAY & NIGHT	
Day & Night Mode	<p><b>AUTO : READ TIME(3~63) / S-LEVEL(0~100) / E-LEVEL(0~100)</b></p> <p><b>COLOR----&gt;BW : B&amp;W</b> : Switching from COLOR to BW; If the number is higher, the camera will only switch during a super low light condition</p> <p><b>BW ----&gt;COLOR</b> : Switching from BW to COLOR; This number should be always lower than COLOR to BW</p> <p><b>Read Time</b> : time interval to switch from COLOR to BW</p> <p>COLOR</p> <p>B&amp;W Mode : BURST (OFF / ON) There is less noise when the BURST is OFF. SMART IR (OFF / ON)</p>
C-SUP	<b>Color Suppression</b> : Color will be reduced at low illumination, if the C-SUP Level is set higher. 0 ~ 63
A-SUP	<b>Aperture Suppression</b> : The sharpness of the edges will be reduced at low illumination, if A-SUP level is set higher. 0 ~ 15
EXIT JUMP	EXIT / SAVE&EXIT / FACTORY SET

FUNCTION	
MIRROR	OFF/MIRROR/V-FLIP/ROTATE
SHARPNESS	0 ~ 31
GAMMA	0.05 ~ 1.00
FREEZE	OFF / ON
NEGATIVE	OFF / ON
D-ZOOM	OFF / ON (x1.0 ~ x32 PTZ)
3D-DNR	ON (0~100) / OFF 3D Digital Noise Reduction
DRC	OFF / INDOOR / OUTDOOR Dynamic Range Compressor
EXIT JUMP	EXIT / SAVE&EXIT / FACTORY SET
MOTION (OMNI-Plus Camera Only)	
MOTION	OFF ↴
	ON
	AREA SELECT (AREA 1~4)
	AREA SET (POSITION / SIZE)
	SENSITIVITY (0~40)
	MOTION TRACE (OFF / ON)
	MOTION VIEW (OFF / ON)
EXIT JUMP	EXIT / SAVE&EXIT / FACTORY SET
PRIVACY	
PRIVACY	OFF
	ON ↴
	AREA SELECT (1~8)
	AREA SET (POSITION / SIZE)
	COLOR (0~15)
EXIT JUMP	EXIT / SAVE&EXIT / FACTORY SET



SYNC	
SYNC	INTERNAL / AUTO
EXIT JUMP	EXIT / SAVE & EXIT / FACTORY SET
SETUP	
TITLE EDIT	OFF / ON
PC CONTROL (RS485 Control)	CAM ID / ID DISPLAY (OFF/ON) / BAUDRATE (2400 / 4800 / 9600) The protocol is fixed pelco-D.
LANGUAGE	ENG / KOR / JPN / CHN1 / CHN2 / RUS / FRAN / SPAN / ITAL
MONITOR	CRT / LCD Select LCD only if the camera is directly connected to the LCD monitor.
OSD COLOR	0 ~ 15
OMNI LENS	OFF (OMNI-Plus Camera Only)
	ON ↴ ALARM / READ TIME / ALARM ZOOM / STAND BY / RETURN
DEFECT	WHITE DEFECT CANCEL MODE
EXIT JUMP	EXIT / SAVE&EXIT / FACTORY SET
EXIT	
EXIT	
SAVE&EXIT	
FACTORY SET	





## MODULE OSD MENU\* -D2367WD, D2367WTIR, D2382TIR

EXPOSURE	COLOR	DAY&NIGHT
 <ul style="list-style-type: none"> <li>BRIGHTNESS</li> <li>SHUTTER</li> <li>BLC</li> <li>AGC</li> <li>MAX_DR</li> <li>STARLIGHT</li> </ul>	 <ul style="list-style-type: none"> <li>WB MODE</li> <li>R-Y GAIN</li> <li>B-Y GAIN</li> </ul>	 <ul style="list-style-type: none"> <li>D&amp;N MODE</li> <li>C_SUP</li> <li>A_SUP</li> </ul>
FUNCTION	MOTION	PRIVACY
 <ul style="list-style-type: none"> <li>MIRROR</li> <li>SHARPNESS</li> <li>GAMMA</li> <li>FREEZE</li> <li>NEGATIVE</li> <li>3D DNR</li> <li>D-ZOOM</li> <li>SLC</li> <li>HME</li> <li>DIS</li> </ul>	 <ul style="list-style-type: none"> <li>MOTION</li> </ul>	 <ul style="list-style-type: none"> <li>MASK 1</li> <li>MASK 2</li> <li>MASK 3</li> <li>MASK 4</li> <li>MASK 5</li> <li>MASK 6</li> </ul>
SYNC	SETUP	EXIT
 <ul style="list-style-type: none"> <li>— SYNC</li> </ul>	 <ul style="list-style-type: none"> <li>CAMERA ID</li> <li>TITLE</li> <li>DPC</li> <li>MONITOR</li> <li>LANGUAGE</li> <li>BAUDRATE</li> <li>OMNI LENS</li> </ul>	 <ul style="list-style-type: none"> <li>EXIT</li> <li>SAVE &amp; EXIT</li> <li>FACTORY RESET</li> </ul>

## OSD MENU\* -D2367WD, D2367WTIR

EXPOSURE	
LENS	DC (0~100) / MANUAL / VIDEO. (DC Lens is recommended.)
SHUTTER	1/60, 1/100FLC, 1/120 ~ 1/100000
BLC	OFF / ON Back Light Compensation
AGC	HIGH / MIDDLE / LOW / OFF Auto Gain Control
MAX-DR	OFF / ON (0~ 20) (Electronic Wide Dynamic Range)
STARIGHT	OFF / AUTO (x2 ~ x256) x32 is recommended.
EXIT JUMP	EXIT / SAVE&EXIT / FACTORY SET
COLOR	
WB MODE	AWC / ATW / MANUAL / PUSH LOCK
R-Y GAIN	0 ~ 100
B-Y GAIN	0 ~ 100
DAY & NIGHT	
Day & Night Mode	<b>AUTO / COLOR / BW / EX-CONT</b> <b>COLOR</b> ----> <b>BW</b> : Switching from color to BW; if the number is higher, the camera will only switch during a super low light condition. <b>BW</b> ----> <b>COLOR</b> : Switching from BW to color; this number should always be lower than COLOR to BW <b>Read Time</b> : Time interval to switch from Color to Black-and-White
	COLOR
	B&W: (BURST:OFF/ON) When the burst is OFF will make less noise
C-SUP	<b>Color Suppression</b> : Color will be reduced at low illumination, if the C-SUP Level is higher. 0 ~ 100 (Not Available when DNR is On.)
A-SUP	<b>Aperture Suppression</b> : The sharpness of the edges will be reduced at low illumination, if A-SUP Level is higher. 0 ~ 100 (Not Available when DNR is On.)
EXIT JUMP	EXIT / SAVE&EXIT / FACTORY SET

 <b>FUNCTION</b>	
MIRROR	OFF/MIRROR/V-FLIP/ROTATE
SHARPNESS	0 ~ 31
GAMMA	0.05 ~ 1.00 / USER
FREEZE	OFF / ON
NEGATIVE	OFF/ ON
3D-DNR	OFF / LOW / MIDDLE / HIGH 3D Digital Noise Reduction
D-ZOOM	OFF / ON (x1.0 ~ x32 PTZ)
SLC	OFF / ON Side Light Compensation
HME	OFF / ON Highlight Masking Exposure
DIS	OFF / ON Digital Image Stabilizer
EXIT JUMP	EXIT / SAVE&EXIT / FACTORY SET
 <b>MOTION (OMNI-Plus Cameras Only)</b>	
MOTION	OFF / ON
	SET WINDOW
	ALL SET (Set the Entire Screen)
	ALL CLEAR (Clear the Entire Screen)
	SENSITIVITY (1 ~ 120)
	SHOW INDICATOR (OFF / ICON / TRACE)
	DELAY OUT (1 ~ 15) Motion Alarm Zoom-In Delay
EXIT JUMP	EXIT / SAVE&EXIT / FACTORY SET

 <b>PRIVACY</b>	
	MASK 1 OFF / ON
	MASK 2 OFF / ON
	MASK 3 OFF / ON
	MASK 4 OFF / ON
	MASK 5 OFF / ON
	MASK 6 OFF / ON
EXIT JUMP	EXIT / SAVE&EXIT / FACTORY SET
 <b>SYNC</b>	
SYNC	INTERNAL / AUTO
V-PHASE	0 ~ 199
EXIT JUMP	EXIT / SAVE&EXIT / FACTORY SET
 <b>SETUP</b>	
CAMERA ID	0 ~ 255
TITLE EDIT	OFF / ON
DPC	OFF / AUTO DPC (Dead Pixels Cancellation)
MONITOR	CRT / LCD
LANGUAGE	English,Japanese, Chinese
BAUDRATE	2400 / 4800 / 9600 / 14400 / 19200 / 38400. <b>Protocol is Pelco-D(fixed cannot be changed;hardcodedinto the DSP)</b>
OMNI LENS	OFF / 1 ~ 10 (OMNI-Plus Cameras Only)
EXIT JUMP	EXIT / SAVE&EXIT / FACTORY SET
 <b>EXIT</b>	
EXIT	Exit the menu
SAVE&EXIT	Exit the menu and save the setting
FACTORY SET	Reset the menu setting to factory default



# OSD MENU\*

-D2382TIR

EXPOSURE	
LENS	DC (0~100) / MANUAL / VIDEO. (DC Lens is recommended.)
SHUTTER	1/160 1/100 / FLC / 1/250 ~ 10000 / SENS-UP x2 ~ x250
BLC	OFF / ON , BLC (Back Light Compensation)
AGC	HIGH / MIDDLE / LOW / OFF AGC (Auto GainControl)
MAX-DR	OFF / ON (0~ 20) (Electronic WideDynamic Range)
STARIGHT	AUTO (x2 ~ x250) / OFF (x32 is recommended.)
EXIT JUMP	EXIT / SAVE&EXIT / FACTORY SET
COLOR	
WB MODE	AWC / ATW / MANUAL / PUSH LOCK
R-Y GAIN	0 ~ 100
B-Y GAIN	0 ~ 100
DAY & NIGHT	
Day & Night Mode	<b>AUTO/ COLOR/ BW / EX-CONT</b> <b>COLOR</b> ----> <b>BW</b> : Switching fromcolor to BW; if the number is higher, the camera will only switch during a super low light condition. <b>BW</b> ----> <b>COLOR</b> : Switching from BW to color; this number should always be lower than COLOR to BW <b>Read Time</b> : Timeinterval to switch from Color to Black-and-White
	COLOR
	B&W: (BURST:OFF/ON) Whenthe burst is OFF will make less noise
C-SUP	<b>Color Suppression</b> :Color will be reduced at low illumination, if the C-SUP Level is higher. 0 ~ 100 (Not Available when DNR is On.)
A-SUP	<b>ApertureSuppression</b> : The sharpness of the edges will be reduced at low illumination, if A-SUP Level is higher. 0 ~ 100 (Not Available when DNR is On.)
EXIT JUMP	EXIT / SAVE&EXIT / FACTORY SET

FUNCTION	
MIRROR	OFF/MIRROR/V-FLIP/ROTATE
SHARPNESS	0 ~ 31
GAMMA	0.05 ~ 1.00 / USER
FREEZE	OFF / ON
NEGATIVE	OFF/ON
3D-DNR	OFF / LOW / MIDDLE / HIGH, 3D-DNR (3D Digital Noise Reduction)
D-ZOOM	OFF / ON (x1.0 ~ x32 PTZ)
SLC	OFF / ON SLC (Side Light Compensation)
HME	OFF / ON HME (Highlight Masking Exposure)
DIS	OFF / ON DIS (Digital Image Stabilizer)
EXIT JUMP	EXIT / SAVE&EXIT / FACTORY SET
MOTION (Omni-Focus Lens Only)	
	OFF / ON
	SET WINDOW
	ALL SET (Set the Entire Screen)
	ALL CLEAR (Clear the Entire Screen)
	SENSITIVITY (1 ~ 120)
	SHOW INDICATOR (OFF / ICON / TRACE)
	DELAY OUT (1 ~ 15) Motion Alarm Zoom-In Delay
EXIT JUMP	EXIT / SAVE&EXIT / FACTORY SET

## Motion Alarm Setup

1. Go to Motion Menu
2. Set Motion to "ON"
3. Click [Set Windows] and set your area of the motion detection
4. Press the Left Arrow button, until you exit back to the Motion Menu
5. Zoom out to the farthest you want the camera to zoom out and press [7](Wide)
6. Zoom in to the farthest you want the camera to zoom in and press [8](Tele)
7. Click [Exit Jump] then click [Save & Exit]
8. Once you are out of the menu press [9](ON/OFF) to activate motion alarm

## MODULE OSD MENU\* -D2365T

PRIVACY	
	MASK 1 OFF / ON
	MASK 2 OFF / ON
	MASK 3 OFF / ON
	MASK 4 OFF / ON
	MASK 5 OFF / ON
	MASK 6 OFF / ON
EXIT JUMP	EXIT / SAVE&EXIT / FACTORY SET
SYNC	
SYNC	INTERNAL / AUTO
V-PHASE	0 ~ 199
EXIT JUMP	EXIT / SAVE&EXIT / FACTORY SET
SETUP	
CAMERA ID	0 ~ 255
TITLE EDIT	OFF / ON
DPC	OFF / AUTO DPC (Dead Pixels Cancellation)
MONITOR	CRT / LCD
LANGUAGE	English, Japanese, Chinese
BAUDRATE	2400 / 4800 / 9600 / 14400 / 19200 / 38400. <b>Protocol is Pelco-D</b> (fixed cannot be changed;hardcoded into the DSP)
OMNI LENS	OFF / 1 ~ 10 (for OMNI-PLUS CAMERA only)
EXIT JUMP	EXIT / SAVE&EXIT / FACTORY SET
EXIT	
EXIT	Exit the menu
SAVE&EXIT	Exit the menu and save the setting
FACTORY SET	Reset the menu setting to factory default

EXPOSURE		COLOR		DAY&NIGHT	
	<ul style="list-style-type: none"> <li>BRIGHTNESS</li> <li>AE PREFERENCE</li> <li>WDR</li> <li>BLC</li> <li>AGC</li> <li>STARLIGHT</li> <li>METER ZONE</li> </ul>		<ul style="list-style-type: none"> <li>WB MODE</li> <li>COLOR GAIN</li> </ul>		<ul style="list-style-type: none"> <li>D&amp;N MODE</li> </ul>
FUNCTION		MOTION		PRIVACY	
	<ul style="list-style-type: none"> <li>MIRROR</li> <li>SHARPNESS</li> <li>GAMMA</li> <li>3D DNR</li> <li>D-ZOOM</li> </ul>		<ul style="list-style-type: none"> <li>MOTION</li> </ul>		<ul style="list-style-type: none"> <li>PRIVACY</li> </ul>
SYNC		SETUP		EXIT	
	<ul style="list-style-type: none"> <li>SYNC</li> </ul>		<ul style="list-style-type: none"> <li>PC CONTROL</li> <li>TITLE</li> <li>LANGUAGE</li> <li>MONITOR</li> <li>OMNI LENS</li> <li>FLUORESCENT</li> <li>DIGITAL VIDEO</li> <li>OUT</li> </ul>		<ul style="list-style-type: none"> <li>EXIT</li> <li>SAVE &amp; EXIT</li> <li>FACTORY RESET</li> </ul>

# OSD MENU\*

-D2365T

EXPOSURE	
BRIGHTNESS	-48 ~ 60
AE PREFERENCE	OUTDOOR / INDOOR
BLC	OFF / BLC (PERCENTILE 10 ~ 50)
WDR	LOW / NORMAL / MEDIUM / HIGH / CUSTOM
AGC	LOW / MEDIUM / HIGH / CUSTOM
STARLIGHT	x2 ~ x64 / OFF
METER ZONE	ADJUST ZONE 1 / ADJUST ZONE 2
EXIT JUMP	EXIT / SAVE&EXIT / FACTORY SET
COLOR	
WB MODE	AWC / ATW(2,000K~11,000K) / PUSH LOCK / MANUAL (KELVIN:2,000L~11,000K / R/B:RED:-20~20 BLUE:-20~20)
COLOR GAIN	-8 ~8
EXIT JUMP	EXIT / SAVE&EXIT / FACTORY SET
DAY & NIGHT	
D&N MODE	AUTO / AUTO(EXT) / COLOR / B&W - AUTO Mode:(READ TIME:0~255/S-LEVEL:0~60/E-LEVEL:0~60/BW AGC:0~60) - AUTO(EXE) Mode:(Option-IR LED Mode) - COLOR Mode - B&W Mode
	BW BURST (OFF / ON)
EXIT JUMP	EXIT / SAVE&EXIT / FACTORY SET

FUNCTION	
MIRROR	OFF / MIRROR / V-FLIP / ROTATE
SHARPNESS	-8 ~ 8
GAMMA	25(0.25) ~ 100(1.0)
3D DNR	MOVIE / INFO
D-ZOOM	ZOOM:1(x1.0) ~ 12(x8) PAN(-100~100)/TILT(-100~100) (Digital Zoom/Pan using the camera mini joystick)
EXIT JUMP	EXIT / SAVE&EXIT / FACTORY SET
MOTION	
	OFF / ON (ACTIVITY THR (0 ~ 255))
	SET MOTION ZONES ⏏
	- 1 ZONE / 1 ~ 2 ZONE / 1 ~ 3 ZONE / 1 ~ 4 ZONE
MOTION	- ADJUST ZONE 1 (MOVE/MAKES WIDE/MAKES NARROW)
	- ADJUST ZONE 2 (MOVE/MAKES WIDE/MAKES NARROW)
	- ADJUST ZONE 3 (MOVE/MAKES WIDE/MAKES NARROW)
	- ADJUST ZONE 4 (MOVE/MAKES WIDE/MAKES NARROW)
	RETURN
EXIT JUMP	EXIT / SAVE&EXIT / FACTORY SET
PRIVACY	
	OFF
	ON ⏏
	- AREA 1 OFF/ON ⏏ (MOVE/MAKES WIDE, MAKES NARROW)
	- AREA 2 OFF/ON ⏏ (MOVE/MAKES WIDE, MAKES NARROW)
PRIVACY	- AREA 3 OFF/ON ⏏ (MOVE/MAKES WIDE, MAKES NARROW)
	- AREA 4 OFF/ON ⏏ (MOVE/MAKES WIDE, MAKES NARROW)
	- AREA 5 OFF/ON ⏏ (MOVE/MAKES WIDE, MAKES NARROW)
	- AREA 6 OFF/ON ⏏ (MOVE/MAKES WIDE, MAKES NARROW)
	RETURN
EXIT JUMP	EXIT / SAVE&EXIT / FACTORY SET

## SPECIFICATIONS\*

SYNC	
SYNC	INT1(SYNC to 59.64Hz)/INT2(SYNC to 60.01Hz)/LL LIMIT/V PHASE/RETURN)
EXIT JUMP	EXIT / SAVE&EXIT / FACTORY SET
SETUP	
PC CONTROL	CAM ID:1 ~ 255 ID DISPLAY : OFF / ON PROTOCOL : PELCO-D BAUDRATE : 2400/4800/9600/19200 RETURN   ┐
TITLE	OFF / ON   (TITLE/ID POSITION(UP-LEFT/UP-CENTER/UP-RIGHT/DOWN-LEFT/ DOWN-CENTER/DOWN-RIGHT)
LANGUAGE	ENGLISH
MONITOR	CRT / LCD
OMNI LENS	OFF┐ ON   ALARM OFF ALARM ON(READ TIME(5~15)/ALARM ZOOM(4~214)/STAND BY(0~214)/RETURN)
FLUORESCENT	OFF / CRR(Manual Lens, Color Rolling/Flickerless Mode)/ CRR2(DC Lens, Color Rolling Mode)
DIGITAL VIDEO OUTPUT	DIGITAL OUT (OFF / ON)
	FIELD ORDER (NORMAL / REVERS)
	FRAME RPT (OFF / 2X / FREEZE)
	RETURN
EXIT JUMP	EXIT / SAVE&EXIT / FACTORY SET
EXIT	
EXIT	
SAVE & EXIT	
FACTORY SET	

Model	D2362DIR	
Camera TYPE	Color/BW	Plastic 18IR-LED Day/Night Digital Dome Camera
Image	Mount	Surface
	Size	1/3"
	Pixels-Total	811(H) x 508(V)
Scanning	Pixels-Effective	768(H) x 494(V)
	System	525 line, 2:1Interlace
	Horizontal Frequency Internal Mode	15,734Hz
Min. Scene Illumination	Vertical Frequency Internal Mode	59.94Hz
	IR-LED On	0.0 Lux
	BLC	ON / OFF (Area Setting)
Functions	AGC	ON / OFF (Gain Adjust)
	AWB	ATW / AWC / MANUAL / PUSH LOCK
	DRC	ON / OFF
Lens	Motion Detection	ON / OFF
	Privacy Zone	4 Programmable Zone / Size
	Focal Length	3.3 ~ 12mm Varifocal Auto Iris Lens
Resolution	Horizontal	540 TV Lines [at TDN (B/W) :560 TV Lines]
Video Output	VBS 1.0Vp-p	VBS 1.0Vp-p(75 Load)
S/N Ratio	S/N Ratio	50dB
OSD	OSD	YES
Environmental Conditions	Operating Temperature	-10°C ~ +55°C(14°F ~ 131°F)
	Humidity	Less than 90%
Power	Power Requirement	12VDC
	Power Consumption	0.9W, 75mA / 2.9W, 242mA (LED ON)
Physical Specification	Dimensions(φ x H)	110.3 X 134.9mm, 4.34 X 5.31in

## SPECIFICATIONS\*

Model	D2363D	
Camera TYPE	Color/BW	Indoor Dome Camera
<b>Image</b>	Mount	Surface
	Device	1/3" High Resolution CCD
	Pixels-Total	811 (H) x 508 (V)
	Pixels-Effective	768 (H) x 494 (V)
<b>VV Scanning</b>	System	525 line, 2:1Interlace
	Horizontal Frequency Internal Mode	15,734Hz
	Horizontal Frequency Line-Lock Mode	15.750Hz
	Vertical Frequency Internal Mode	59.94Hz
	Vertical Frequency Line-Lock Mode	60Hz
<b>Min. Scene Illumination</b>	F1.2	0.14 Lux
<b>Functions</b>	Sens-up	OFF / AUTO(x256)
	DNR	OFF / AUTO
	AGC	OFF / LOW / MIDDLE / HIGH
	AWB	ATW/AWC/INDOOR/OUTDOOR/MANUAL/PUSH LOCK
	Motion Detection	ON / OFF (Area, Sensitivity, Trace)
	Privacy Zone	8 Programmable Zone / Size
<b>Lens</b>	Focal Length	3.3~12mm
<b>Resolution</b>	Horizontal	540 TV Lines
<b>Video Output</b>	VBS 1.0Vp-p	VBS 1.0Vp-p(75 Load)
<b>S/N Ratio</b>	S/N Ratio	52dB
<b>OSD</b>	OSD	YES
<b>Environmental Conditions</b>	Operating Temperature	-10°C ~ +55°C(14°F ~ 131°F)
	Humidity	Less than 90%
<b>Power</b>	Power Requirement	12VDC / 24VAC
	Power Consumption	12VDC: 1.96W, 163.3mA / AC24V: 2.2W, 91.7mA
<b>Physical Specification</b>	Dimensions(H x L)	110.3 X 134.9mm (4.34x5.31in)
<b>Certifications</b>	CE, FCC, RoHS	Certified

## SPECIFICATIONS\*

Model	D2363TIR	
Camera TYPE	Color/BW	Indoor Dome Camera
<b>Image</b>	Mount	Surface
	Device	1/3" High Resolution CCD
	Pixels-Total	811 (H) x 508 (V)
	Pixels-Effective	768 (H) x 494 (V)
<b>VV Scanning</b>	System	525 line, 2:1Interlace
	Horizontal Frequency Internal Mode	15,734Hz
	Horizontal Frequency Line-Lock Mode	15.750Hz
	Vertical Frequency Internal Mode	59.94Hz
	Vertical Frequency Line-Lock Mode	60Hz
<b>Min. Scene Illumination</b>	IR-LED On IR Distance	0.0LUX 100ft Range
<b>Functions</b>	Sens-up	OFF / AUTO(x256)
	DNR	OFF / AUTO
	AGC	OFF / LOW / MIDDLE / HIGH
	AWB	ATW/AWC/INDOOR/OUTDOOR/MANUAL/PUSH LOCK
	Motion Detection	ON / OFF (Area, Sensitivity, Trace)
	Privacy Zone	8 Programmable Zone / Size
<b>Lens</b>	Focal Length	3.3~12mm
<b>Resolution</b>	Horizontal	540 TV Lines
<b>Video Output</b>	VBS 1.0Vp-p	VBS 1.0Vp-p(75 Load)
<b>S/N Ratio</b>	S/N Ratio	52dB
<b>OSD</b>	OSD	YES
<b>Environmental Conditions</b>	Operating Temperature	-10°C ~ +55°C(14°F ~ 131°F)
	Humidity	Less than 90%
<b>Power</b>	Power Requirement	12VDC / 24VAC
	Power Consumption	12VDC: 1.96W, 163.3mA / 24VAC: 2.2W, 91.7mA 12VDC: 4.3W, 358.3mA / 24VAC: 3.0W, 125mA(LED ON)
<b>Physical Specification</b>	Dimensions(H x L)	110.3 X 134.9 mm (4.34x5.31in)
<b>Certifications</b>	CE, FCC, RoHS	Certified

## SPECIFICATIONS\*

Model	D2367WD	
Camera TYPE	Color/BW	Indoor Dome Camera
<b>Image</b>	Mount	Surface
	Device	Super HAD II CCD
	Size	1/3"
	Pixels-Total	811 (H) x 508 (V)
<b>Scanning</b>	Pixels-Effective	768 (H) x 494 (V)
	System	525 line, 2:1Interlace
	Horizontal Frequency Internal Mode	15,734Hz
<b>Min. Scene Illumination</b>	Vertical Frequency Internal Mode	59.94Hz
	F1.2	0.14 Lux [Color], 0.03 Lux [B/W]
<b>Functions</b>	DIS	ON/OFF
	AGC	HIGH / MIDDLE / LOW / OFF
	EWDR	OFF / ON
	Mirror	OFF / MIRROR / V-FLIP / ROTATE
	STAR-LIGHT	OFF / AUTO (x2 ~ x256)
	Privacy Zone	6 Programmable Zone / Size
<b>Lens</b>	Focal Length	3.3~12mm Varifocal Auto Iris Lens
<b>Resolution</b>	Horizontal	560 TV Lines [Color]; 580 TV Lines [BW]
<b>Video Output</b>	VBS 1.0Vp-p	VBS 1.0Vp-p(75 Load)
<b>S/N Ratio</b>	S/N Ratio	50dB
<b>OSD</b>	OSD	YES
<b>Environmental Conditions</b>	Operating Temperature	-10°C ~ +55°C(14°F ~ 131°F)
	Humidity	Less than 90%
<b>Power</b>	Power Requirement	12VDC / 24VAC
	Power Consumption	12VDC: 1.8W, 150mA / 24VAC: 2.4W, 100mA

## SPECIFICATIONS\*

Model	D2367WTIR	
Camera TYPE	Color/BW	Indoor Dome Camera
<b>Image</b>	Mount	Surface
	Device	Super HAD II CCD
	Size	1/3"
	Pixels-Total	811 (H) x 508 (V)
<b>Scanning</b>	Pixels-Effective	768 (H) x 494 (V)
	System	525 line, 2:1Interlace
	Horizontal Frequency Internal Mode	15,734Hz
<b>Min. Scene Illumination</b>	Vertical Frequency Internal Mode	59.94Hz
	IR-LED On	0.0Lux
<b>Functions</b>	IR Distance	100ft Range
	AGC	HIGH / MIDDLE / LOW / OFF
	STAR-LIGHT	AUTO (x2 ~ x250) / OFF
	3D-DNR	OFF / ON
	HME	OFF / ON
	DIS	OFF / ON
<b>Lens</b>	Privacy Zone	6 Programmable Zone / Size
	Focal Length	3.3~12mm Varifocal Auto Iris Lens
<b>Resolution</b>	Horizontal	560 TV Lines [Color]; 580 TV Lines [BW]
<b>Video Output</b>	VBS 1.0Vp-p	VBS 1.0Vp-p(75 Load)
<b>S/N Ratio</b>	S/N Ratio	50dB
<b>OSD</b>	OSD	YES
<b>Environmental Conditions</b>	Operating Temperature	-10°C ~ +55°C(14°F ~ 131°F)
	Humidity	Less than 90%
<b>Power</b>	Power Requirement	12VDC / 24VAC
	Power Consumption	12VDC: 1.8W, 150mA / 24VAC: 2.4W, 100mA 12VDC: 4.6W, 383.3mA / 24VAC: 4.9W, 204.2mA

## SPECIFICATIONS\*

Model	D2382TIR	
Camera TYPE	Color/BW	Indoor Dome Camera
<b>Image</b>	Mount	Surface
	Device	Super HAD II CCD
	Size	1/3"
	Pixels-Total	811 (H) x 508 (V)
<b>Scanning</b>	Pixels-Effective	768 (H) x 494 (V)
	System	525 line, 2:1Interlace
	Horizontal Frequency Internal Mode	15,734Hz
	Vertical Frequency Internal Mode	59.94Hz
<b>Min. Scene Illumination</b>	IR-LED on	0.0 Lux
<b>Functions</b>	BLC	ON/OFF
	AGC	HIGH/ MIDDLE / LOW /OFF
	MAX-DR	OFF / ON
	Mirror	OFF / MIRROR / V-FLIP / ROTATE
	STAR-LIGHT	AUTO (x2~ x250) / OFF
	3D-DNR	OFF / ON
	SLC	OFF / ON
	HME	OFF / ON
	Motion Detection	OFF / ON (Area / Sensitivity)
	Privacy Zone	6 Programmable Zone / Size
	Focal Length	OMNI-Focus2.9~8.5mm 3x Motorized Zoom, Auto Iris
	Horizontal	560 TV Lines [Color]; 580 TV Lines [BW]
<b>Video Output</b>	VBS 1.0Vp-p	VBS 1.0Vp-p(75 Load)
<b>S/N Ratio</b>	S/N Ratio	50dB
<b>OSD</b>	OSD	YES
<b>Environmental Conditions</b>	Operating Temperature	-10°C ~ +55°C(14°F ~ 131°F)
	Humidity	Less than 90%
<b>Power</b>	Power Requirement	12VDC / 24VAC
	Power Consumption	165mA / 360mA; 4.90Watts / 4.96Watts

## SPECIFICATIONS\*

Model	D2365T	
General Spec		
CCD Type	1/3" 420K Pixels Color	
Total number of pixels	768(H) X 548(V)	
Minimum Illumination	0.22Lux (F1.2, 30IRE-COLOR)	
	0.0Lux (LED ON)	
Resolution	H: 690 TV Lines Effective	
Electric Spec		
Voltage	DC 12[V] (11.0[V] ~ 20.0[V])	
	AC 24[V] (20.0[V] ~ 30.0[V])	
Power Consumption	DC12V-3.1W / AC24V-3.2W	
COMMON		
General Spec		
Shutter speed	1/25 ~ 1/30,720 sec	
S/N Ratio	53dB or More(AGC OFF)	
Gamma	0.45	
Sync System	Internal / Line Lock	
Mechanical Spec		
Operation Temperature	-10°C +50°C (14°F ~ 131°F)	
Storage Temperature	-20°C +70°C	
Operation Humidity	Under 90% (Non-condensing)	

## WARRANTY INFORMATION\*

**Digital Watchdog** (referred to as “the Warrantor”) warrants the Camera Series against defects in materials or workmanship as follows.

**LABOR** : For the initial five (5) years from the date of original purchase, if the camera is determined to be defective, the Warrantor will repair or replace the unit, with new or refurbished product at its option, at no charge.

**PARTS** : In addition, the Warrantor will supply replacement parts for the initial five (5) years.

To obtain warranty or out of warranty service, please contact a Technical Support Representative at **1-866-446-3595** Monday through Friday from 8:30AM to 8:00PM Eastern.

A purchase receipt or other proof of the original purchase date is required before warranty service is rendered. This warranty only covers failures due to defects in materials and workmanship which arise during normal use. This warranty does not cover damage which occurs in shipment or failures which are caused by products not supplied by the Warrantor or failures which result from accident, misuse, abuse, neglect, mishandling, misapplication, alteration, modification, faulty installation, set-up adjustments, improper antenna, inadequate signal pickup, maladjustment of consumer controls, improper operation, power line surge, improper voltage supply, lightning damage, rental use of the product or service by anyone other than an authorized repair facility or damage that is attributable to acts of God.

## LIMITS AND EXCLUSIONS\*

There are no express warranties except as listed above. The Warrantor will not be liable for incidental or consequential damages, including without limitation and damage to recording media, resulting from the use of these products or arising out of any breach of the warranty. All express and implied warranties, including the warranties of merchantability and fitness for particular purpose, are limited to the applicable warranty period set forth above.

Some states do not allow the exclusion or limitation of incidental or consequential damages, or limitations on how long an implied warranty lasts, so the above exclusions or limitations may not apply to you. This warranty gives you specific legal rights, and you may also have other rights that vary from state to state.

If the problem is not handled to your satisfaction, then write to the Address listed on the next page.

Service calls which do not involve defective materials or workmanship as determined by the Warrantor, in its sole discretion, are not covered. Costs of such service calls are the responsibility of the purchaser.