



INDOOR DOME CAMERA

Small Commercial, Residential, Transportation,
Education, Retail and C-Store



D4252 / Indoor Dome, 420 Lines, 2.9mm Fixed Lens

High quality and attractive style are what makes the Indoor Dome D4252 the perfect solution for many cost sensitive applications. Its compact size size along with its unique mounting bracket makes installation as simple as possible. This model offers a 2.9mm fixed lens for general viewing applications, and our 1/3" Samsung CCD chip set offers sharp, clear images, which is why it is an easy choice for small security applications. When selecting a high quality indoor dome camera that must meet a value to cost ratio, choose the Digital Watchdog camera series. Each model includes a power supply and a five year warranty.





Dimensions

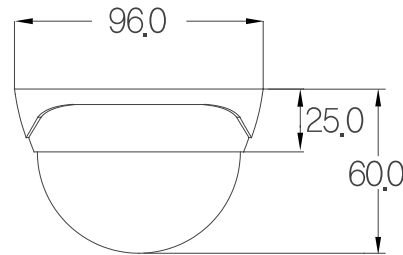

Summary

High quality and attractive style is what makes the D4252 the perfect solution for many cost sensitive applications. Its compact size makes installation as easy as possible. The camera offers a wide-angle fixed lens for general viewing applications, and its 1/3" Samsung CCD chip offers sharp, clear images, making the camera the best choice for small security applications. Each model includes a power supply and a five year warranty.

Features

- 1/3" Samsung CCD
- 420 TV Lines
- 2.9mm Fixed Lens
- AWB (Auto White Balance)
- Wide Operating Voltage (8VDC-18VDC)
- Low Power Consumption
- Clear Image
- CE, FCC, RoHS Certified
- Small and Compact Size for Most Applications
- Affordable for Simple Security Applications
- Decora White
- 12VDC Transformer Included
- 5 Year Limited Warranty

Specifications

Model	DWC-D4252
Image Sensor	1/3" Samsung CCD
Pixels-Total	537 (H) x 505 (V)
Pixels-Effective	510 (H) x 492 (V)
Scanning System	525 Line, 2:1 Interlace
Minimum Illumination	F2.0: 0.42 Lux
Horizontal Resolution	420 TV Lines
Focal Length	2.9mm Fixed
Power Requirement	DC 12V
Power Consumption	DC12V: 0.9W, 75mA N/A
Video Output	VBS 1.0Vp-p (75 Load)
S/N Ratio	48dB
Dimensions	95.6 x 66 mm (3.76 x 2.60 in)
Weight	0.4 lbs
Operation Temperature	-10°C ~ +55 °C (14 °F ~ 131 °F)
Storage Temperature	-20°C ~ +70 °C (-4 °F ~ 158 °F)
Operation Humidity	Less than 90%

(*) Specification is subject to change without prior notice.

