

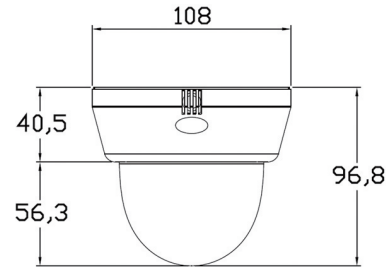

Dimensions



Summary

Our new simple to install housing series combined with our reliable camera technology series gives you a high quality camera in just a few minutes. All Snapit housings include both a built-in UTP and RS-485.

Our Snapit Indoor Dome D4363TIR is powered by our Star-Light technology, which offers super low light imaging for any application. At night, our Smart IR technology illuminates the scene up to 70 feet without added lighting.

3 Axis Gimbal

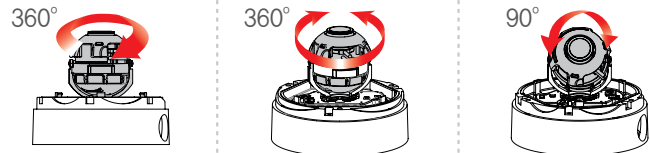

Features

- 1/3" Sony Super HAD II CCD
- 560 TV Lines
- 3.3~12mm Varifocal Auto Iris Lens
- 70ft Range IR with Intelligent Camera Sync
- TDN (True Day and Night/TDN5)
- Star-Light (Super Low Light Technology)
- 3D-DNR (3D Digital Noise Reduction)
- DRC (Dynamic Range Compressor)
- HME (Highlight Masking Exposure)
- AGC (Auto Gain Control)
- BLC (Back Light Compensation)
- AWB (Auto White Balance)
- Negative Imaging
- Mirror Image Control
- UTP / RS485 Built-in
- Programmable Privacy Zone (8) & Motion Detection
- Easy Icon Driven OSD Menu with Built-in Joystick
- Auto Sensing 24 VAC / 12 VDC with Line Lock
- Secondary Video-BNC Output

Specifications

Model	DWC-D4363TIR
Image Sensor	1/3" Super II HAD CCD
Pixels-Total	811 (H) X 508 (V)
Pixels-Effective	768 (H) x 494 (V)
Minimum Illumination	0.14Lux (F1.2, 30IRE-COLOR)
	0.0 Lux (LED ON)
Horizontal Resolution	560 TV Lines (COLOR)
	580 TV Lines (BW)
Power Requirement	DC12V / AC24V
Power Consumption	DC12V: 2.3W, 191.7mA / AC24V: 2.5W, 104mA
	DC12V: 4.8W, 400mA / AC24V: 4.9W, 204mA LED ON
Shutter Speed	1/60s ~ 1/100000s
S/N Ratio	52dB
Gamma	0.45
Sync System	Internal / Line Lock
Operation Temperature	-10°C ~ +55°C (14°F ~ 131°F)
Storage Temperature	-20°C ~ +70°C (-4°F ~ 158°F)
Operation Humidity	Under 90% (Non-Condensing)

(*) Specification is subject to change without prior notice.

