

DW DIGITAL WATCH-DOG



It's quick. It's easy!

Snapit

Easy Installation 1 2 3

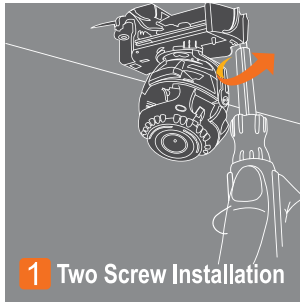

1 Two Screw Installation

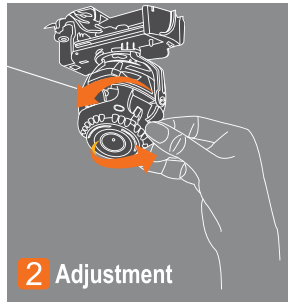

2 Adjustment

Completing your installations quickly is a Snap!

Indoor Dome Camera D4365T

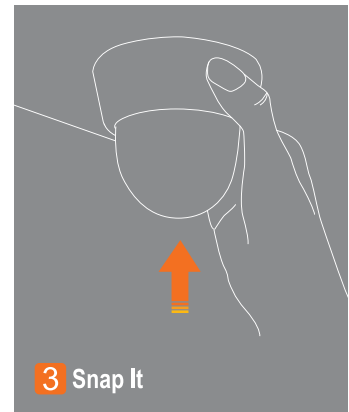

3 Snap It

DW DIGITAL WATCHDOG
Everything's Digital

RS485





PIXIM

New ICON Driven OSD Menu

ICON Type Menu will easily guide you through programming options. Simple and fast programming.



3D-DNR (Digital Noise Reduction)

Produces less noise and more color at night. An excellent choice.



Smear Canceling Circuit

Eliminates glares and reflections from the video images.



Powerful WDR (Overexposure Elimination)

Eliminates overexposure to capture all the details of scene.



Powerful WDR (Underexposure Elimination)

Eliminates underexposure to capture all the details of scene.



3 Axis Gimbal

Choose the exact scene you wish to view with our flexible 3-Axis Gimbal technology.





Dimensions

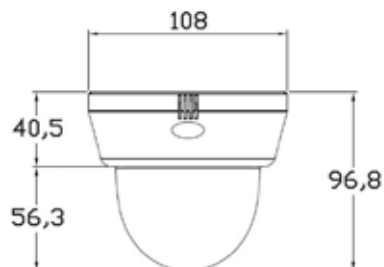

Summary

Our new simple to install housing series combined with our reliable camera technology series gives you a high quality camera in just a few minutes. All Snapit housings include both a built-in UTP and RS-485.

Our Snapit Indoor Dome D4365T is powered by PIXIM's Seawolf Digital Imaging System. PIXIM's technology allows each pixel to self-adjust in the same scene, giving terrific image quality.



Features

- 1/3" Pixim Seawolf CMOS Sensor
- 690 Horizontal TV Lines
- 3.3~12mm Varifocal Auto Iris Lens
- TDN (True Day and Night/IR Cut Filter)
- Powerful Wide Dynamic Range
- Ultra Low Light Sensitivity
- 3D-DNR (3D Digital Noise Reduction)
- Smear Canceling Circuit
- Low Power Consumption
- UTP / RS485 Built-in
- Programmable Privacy Zone (6) & Motion Detection
- Easy Icon Driven OSD Menu with Built-in Joystick
- Auto Sensing 24 VAC/12 VDC with Line Lock
- Secondary Video-BNC Output
- CE, FCC, RoHS Certified

Specifications

| Model | DWC-D4365T |
|-----------------------|---|
| Image Sensor | 1/3" Pixim Seawolf CMOS Sensor |
| Pixels-Total | 768 (H) x 548 (V) |
| Minimum Illumination | 0.22Lux (F1.2, 30IRE-COLOR) |
| Horizontal Resolution | 690 TV Lines Effective (COLOR) |
| Power Requirement | DC12V / AC24V |
| Power Consumption | DC12V: 3.1W, 258mA / AC24V: 3.2W, 133mA |
| Shutter Speed | 1/25s ~ 1/30,720 sec |
| S/N Ratio | 53dB |
| Gamma | 0.45 |
| Sync System | Internal / Line Lock |
| Operation Temperature | -10°C ~ +55 °C (14 °F ~ 131 °F) |
| Storage Temperature | -20°C ~ +70 °C (-4 °F ~ 158 °F) |
| Operation Humidity | Under 90% (Non-Condensing) |

(*) Specification is subject to change without prior notice.

