

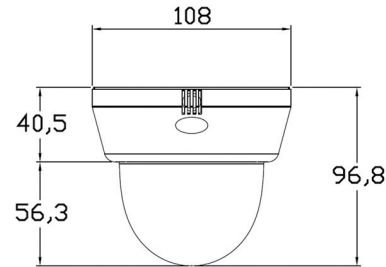

Dimensions



Summary

Our new simple to install housing series combined with our reliable camera technology series gives you a high quality camera in just a few minutes. All Snapit housings include both a built-in UTP and RS-485.

Our Snapit Indoor Dome D4365T is powered by PIXIM's Seawolf Digital Imaging System. PIXIM's technology allows each pixel to self-adjust in the same scene, giving terrific image quality.

3 Axis Gimbal

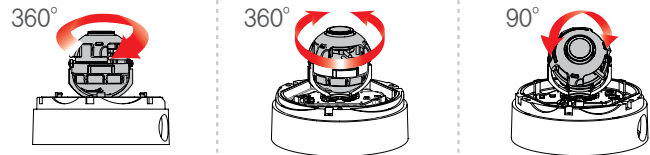

Features

- 1/3" Pixim Seawolf CMOS Sensor
- 690 Horizontal TV Lines
- 3.3~12mm Varifocal Auto Iris Lens
- TDN (True Day and Night/IR Cut Filter)
- Powerful Wide Dynamic Range
- Ultra Low Light Sensitivity
- 3D-DNR (3D Digital Noise Reduction)
- Smear Canceling Circuit
- Low Power Consumption
- UTP / RS485 Built-in
- Programmable Privacy Zone (6) & Motion Detection
- Easy Icon Driven OSD Menu with Built-in Joystick
- Auto Sensing 24 VAC/12 VDC with Line Lock
- Secondary Video-BNC Output

Specifications

Model	DWC-D4365T
Image Sensor	1/3" Pixim Seawolf CMOS Sensor
Pixels-Total	768 (H) x 548 (V)
Minimum Illumination	0.22Lux (F1.2, 30IRE-COLOR)
	0.0 Lux (LED ON)
Horizontal Resolution	690 TV Lines Effective (COLOR)
Power Requirement	DC12V / AC24V
Power Consumption	DC12V: 3.1W, 258mA / AC24V: 3.2W, 133mA
Shutter Speed	1/25s ~ 1/30,720 sec
S/N Ratio	53dB
Gamma	0.45
Sync System	Internal / Line Lock
Operation Temperature	-10°C ~ +55°C (14°F ~ 131°F)
Storage Temperature	-20°C ~ +70°C (-4°F ~ 158°F)
Operation Humidity	Under 90% (Non-Condensing)

(*) Specification is subject to change without prior notice.

