

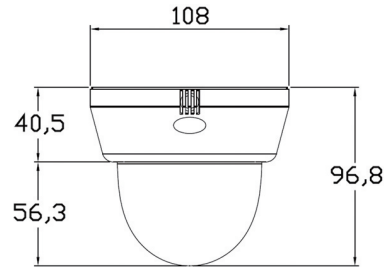

## Dimensions



## Summary

Our new simple to install housing series combined with our reliable camera technology series gives you a high quality camera in just a few minutes. All Snapit housings include both a built-in UTP and RS-485.

Our Snapit Indoor Dome D4382TIR is powered by our Infinity OMNI-Plus technology. The technology simplifies field of view adjustment by offering an OMNI-Focus lens which utilizes three lenses to view fore-, mid-, and background as one.

### 3 Axis Gimbal

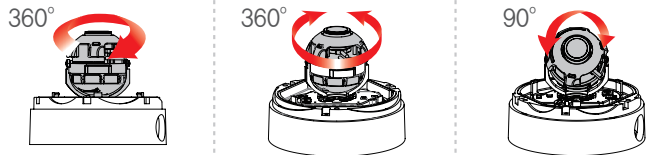

## Features

- 1/3" Sony Super II HAD CCD
- 580 TV Lines
- OMNI-Focus 2.9~8.5mm 3X Motorized Zoom, Auto Iris
- 50ft Range IR with Intelligent Camera Sync
- TDN (True Day and Night/TDN5)
- Star-Light (Super Low Light Technology)
- EWDR (Electronic Wide Dynamic Range)
- 3D-DNR (3D Digital Noise Reduction)
- DIS (Digital Image Stabilizer)
- HME (Highlight Masking Exposure)
- SLC (Side Light Compensation)
- AGC (Auto Gain Control)
- BLC (Back Light Compensation)
- AWB (Auto White Balance)
- Negative Imaging
- Mirror Image Control
- Negative Imaging
- Mirror Image Control
- UTP / RS485 Built-in
- Programmable Privacy Zone (6) & Motion Detection
- Easy Icon Driven OSD Menu with Built-in Joystick
- Auto-Sensing 24 VAC/12 VDC with Line Lock
- Secondary Video-BNC Output

## Specifications

Model	DWC-D4382TIR
Image Sensor	1/3" Super II HAD CCD
Pixels-Total	811 (H) x 508 (V)
Pixels-Effective	768 (H) x 494 (V)
Minimum Illumination	0.14Lux (F1.2, 30IRE-COLOR)
	0.0 Lux (LED ON)
Horizontal Resolution	580 TV Lines (COLOR)
	600 TV Lines (BW)
Power Requirement	DC12V / AC24V
Power Consumption	DC12V: 2.1W, 175mA / AC24V: 2.2W, 91.7mA
	DC12V: 4.5W, 375mA / AC24V: 4.6W, 191.7mA LED ON
Shutter Speed	1/60s ~ 1/100000s
S/N Ratio	50dB
Gamma	0.45
Sync System	Internal / Line Lock
Operation Temperature	-10°C ~ +55°C (14°F ~ 131°F)
Storage Temperature	-20°C ~ +70°C (-4°F ~ 158°F)
Operation Humidity	Under 90% (Non-Condensing)

(\*) Specification is subject to change without prior notice.

