



SEEING IS BELIEVING

960H

CAMERA SERIES BROCHURE

 INFINITY 960H

 STAR-LIGHT™ 960H

VALUE 960H

960HorizontalPixels



BULLET

VANDAL

INDOOR

VMAX960H DVR

For a complete security package, combine the 960H Camera technology with our VMAX960H, a recording solution that will not lose a single detail; from live and record, to playback.



960H Resolution

960 Horizontal Pixels is the highest analog resolution available today. Using existing installation and cabling, Digital Watchdog's Cameras offer visibly clearer and extremely detailed image. Seeing is believing.



HME (Highlight Masking Exposure)

The HME technology detects and masks any strong spots of light to produce a clear image of any environment. HME is particularly effective for reading license plates of cars in streets or parking lots at night.



3D-DNR (Digital Noise Reduction)

The 3D-DNR technology provides clearer images using unique algorithms designed to reduce video noise. It cleans electronic noise signals that reduce the clarity of the image and effect motion detection settings with various recording technology.



Powerful Electronic Wide Dynamic Range

Enables the camera to capture clear images in the same frame, even when there are both very bright and very dark areas in the same field. Available in the Infinity 960H models only.



Day & Night

When light diminishes below a certain level, the camera will automatically switch to night mode, providing high quality black-and-white video images.



INFINITY 960H Bullet Camera B1567WD/TIR



- 960H Image Sensor (960 Horizontal Pixels)
- 700 TV Lines [B/W], 650 TV Lines [Color]
- 3.3~12mm Varifocal Auto Iris Lens
- 100ft Range Smart IR [B1567WTIR Only],
- TDN [True Day & Night]
- EWDR, 3D-DNR
- Starlight [Super Low Light]
- HME
- AGC / BLC / AWB
- IP66 Certified [Weatherproof]
- No Fog or Condensation under Any Weather Condition

Specifications

VIDEO	
Image Sensor	960H CCD
Total Pixels	1020 (H) x 507 (V), 520K Pixels
Scanning System	2 : 1 Interlace
Frequency	15.734KHz (H), 59.95Hz (V)
Synchronization	Internal or Line Lock
Horizontal Resolution	700 TV Lines [B/W], 650 TV Lines [Color]
Minimum Illumination	F1.2 (30IRE): 0.3 Lux [Color] F1.2 (30IRE): 0.0 Lux [B/W]
S/N Ratio	50dB (AGC off)
Video Output	CVBS: 1.0Vp-p / 75 Ω
LENS	
Focal Length	3.3-12mm, DC Auto Iris
IR Distance	100ft Range IR [B1567WTIR Only]
ENVIRONMENTAL	
IP Rating	IP66 (Protects against dust and high pressure water.)

INFINITY 960H SnapIt D4567WD/TIR, V4567WD/TIR



Specifications

VIDEO	
Image Sensor	960H CCD
Total Pixels	1020 (H) x 507 (V), 520K Pixels
Scanning System	2 : 1 Interlace
Frequency	15.734KHz (H), 59.95Hz (V)
Synchronization	Internal or Line Lock
Horizontal Resolution	700 TV Lines [B/W], 650 TV Lines [Color]
Minimum Illumination	F1.2 (30IRE): 0.3 Lux [Color] F1.2 (30IRE): 0.0 Lux [B/W]
S/N Ratio	50dB (AGC off)
Video Output	CVBS: 1.0Vp-p / 75 Ω
LENS	
Focal Length	3.3-12mm, DC Auto Iris
IR Distance	70ft Range IR [D4567WTIR Only]
ENVIRONMENTAL	
IP Rating	IP68 (Waterproof)

- 960H Image Sensor (960 Horizontal Pixels)
- 700 TV Lines [B/W], 650 TV Lines [Color]
- 3.3~12mm Varifocal Auto Iris Lens
- 70ft Range Smart IR, TDN [D4567WTIR, V4567WTIR Only]
- EWDR, 3D-DNR, HME, BLC
- Star-Light [Super Low Light Technology]
- IP68 Certified, Junction Box Built-in [V4567WD, V4567WTIR Only]

Snapit Easy Installation 1234



- 1 Built-in Junction Box Installation
- 2 Snap It
- 3 Adjustment
- 4 Cover

Snapit Easy Installation 123

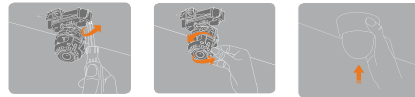

- 1 Two Screw Installation
- 2 Adjustment
- 3 Snap It

Value 960H Bullet Camera B562DIR



- 960H CCD Image Sensor (960 Horizontal Pixels)
- 700 TV Lines [B/W], 650 TV Lines [Color]
- 3.3-12mm Varifocal Auto Iris Lens
- Electronic Day and Night
- 85ft Range IR with Intelligent Camera Sync, Smart IR
- HME [Highlight Masking Exposure]
- AGC, BLC, AWB
- IP66 Certified (Weatherproof)

Specifications

VIDEO	
Image Sensor	960H CCD
Total Pixels	1020 (H) x 507 (V), 520K Pixels
Frequency	15.734KHz (H), 59.95Hz (V)
Horizontal Resolution	700 TV Lines [B/W], 650 TV Lines [Color]
Minimum Illumination	F1.2 (30IRE): 0.3 Lux [Color] F1.2 (30IRE): 0.0 Lux [B/W]
S/N Ratio	50dB (AGC off)
Video Output	CVBS: 1.0Vp-p / 75 Ω
LENS	
Focal Length	3.3-12mm, DC Auto Iris
IR Distance	85ft Range IR
ENVIRONMENTAL	
IP Rating	IP66 (Protects against dust and high pressure water.)

STAR-LIGHT™ 960H Ball Camera BL2553DIR



- 960H Image Sensor [960 Horizontal Pixels]
- 720 TVL [B/W], 700 TVL [Color]
- 3.6mm Fixed Lens
- 50ft Range Smart IR
- Electronic Day & Night
- 3D DNR [3D Digital Noise Reduction]
- Star-Light [Super Low Light Technology]
- HME [Highlight Masking Exposure]
- SLC [Side Light Compensation]
- IP66 Certified (Weatherproof)
- 12VDC only

Specifications

VIDEO	
Image Sensor	960H CCD
Total Pixels	960 (H) x 478 (V)
Scanning System	2 : 1 Interlace
Frequency	15.734KHz (H), 59.95Hz (V)
Synchronization	Internal or Line Lock
Horizontal Resolution	720 TV Lines [B/W], 700 TV Lines [Color]
Minimum Illumination	F1.2 (30IRE): 0.0 Lux
S/N Ratio	52dB (AGC off)
Video Output	CVBS: 1.0Vp-p / 75 Ω
LENS	
Focal Length	3.6mm
Lens Type	Fixed Lens
IR Distance	50ft Range IR
ENVIRONMENTAL	
Operating Temperature	-10°C ~ 50°C (14°F ~ 122°F)
Operating Humidity	Less than 90% (Non-Condensing)
IP Rating	IP66 (Protects against dust and high pressure water.)

STAR-LIGHT™ 960H Indoor Dome Camera D3653D/IR



- 960H Image Sensor [960 Horizontal Pixels]
- 720 TVL [B/W], 700 TVL [Color]
- 2.8~12mm Varifocal Lens
- 100ft Range Smart IR
- Electronic Day & Night
- 3D DNR [3D Digital Noise Reduction]
- Star-Light [Super Low Light Technology]
- HME [Highlight Masking Exposure]
- SLC [Side Light Compensation]
- Auto Sensing 24VAC/12VDC with Line Lock

Specifications

VIDEO	
Image Sensor	960H CCD
Total Pixels	960 (H) x 478 (V)
Scanning System	2 : 1 Interlace
Frequency	15.734KHz (H), 59.95Hz (V)
Synchronization	Internal or Line Lock
Horizontal Resolution	720 TV Lines [B/W], 700 TV Lines [Color]
Minimum Illumination	F1.2 (30IRE): 0.0 Lux
S/N Ratio	52dB (AGC off)
Video Output	CVBS: 1.0Vp-p / 75 Ω
LENS	
Focal Length	2.8-12 mm
Lens Type	Varifocal Auto Iris Lens
IR Distance	100ft Range IR
ENVIRONMENTAL	
Operating Temperature	-10°C ~ 50°C (14°F ~ 122°F)
Operating Humidity	Less than 90% (Non-Condensing)

STAR-LIGHT™ 960H Vandal Fixed Lens Camera V6553D/IR



- 960H Image Sensor [960 Horizontal Pixels]
- 720 TVL [B/W], 700 TVL [Color]
- 3.6mm Fixed Lens
- 100ft Range Smart IR
- Electronic Day & Night
- 3D DNR [3D Digital Noise Reduction]
- Star-Light [Super Low Light Technology]
- HME [Highlight Masking Exposure]
- SLC [Side Light Compensation]
- IP66 Certified (Weatherproof)
- 12VDC Only

Specifications

VIDEO	
Image Sensor	960H CCD
Total Pixels	960 (H) x 478 (V)
Scanning System	2 : 1 Interlace
Frequency	15.734KHz (H), 59.95Hz (V)
Synchronization	Internal or Line Lock
Horizontal Resolution	720 TV Lines [B/W], 700 TV Lines [Color]
Minimum Illumination	F1.2 (30IRE): 0.0 Lux
S/N Ratio	52dB (AGC off)
Video Output	CVBS: 1.0Vp-p / 75 Ω
LENS	
Focal Length	3.6mm
Lens Type	Fixed Lens
IR Distance	100ft Range IR
ENVIRONMENTAL	
Operating Temperature	-10°C ~ 50°C (14°F ~ 122°F)
Operating Humidity	Less than 90% (Non-Condensing)
IP Rating	IP66 (Protects against dust and high pressure water.)

STAR-LIGHT™ 960H Vandal Dome Camera V6563D/IR



- 960H Image Sensor [960 Horizontal Pixels]
- 720 TVL [B/W], 700 TVL [Color]
- 2.8~12mm Varifocal Lens
- 100ft Range Smart IR
- Electronic Day & Night
- 3D DNR [3D Digital Noise Reduction]
- Star-Light [Super Low Light Technology]
- HME [Highlight Masking Exposure]
- SLC [Side Light Compensation]
- IP66 Certified [Weatherproof]
- Auto Sensing 24VAC/12VDC with Line Lock

Specifications

VIDEO	
Image Sensor	960H CCD
Total Pixels	960 (H) x 478 (V)
Scanning System	2 : 1 Interlace
Frequency	15.734KHz (H), 59.95Hz (V)
Synchronization	Internal or Line Lock
Horizontal Resolution	720 TV Lines [B/W], 700 TV Lines [Color]
Minimum Illumination	F1.2 (30IRE): 0.0 Lux
S/N Ratio	52dB (AGC off)
Video Output	CVBS: 1.0Vp-p / 75 Ω
LENS	
Focal Length	2.8~12 mm
Lens Type	Varifocal Auto Iris Lens
IR Distance	100ft Range IR
ENVIRONMENTAL	
Operating Temperature	-10°C ~ 50°C (14°F ~ 122°F)
Operating Humidity	Less than 90% (Non-Condensing)
IP Rating	IP66 (Protects against dust and high pressure water.)

STAR-LIGHT™ 960H Weather Bullet Camera B6563DIR/ TIR550



- 960H Image Sensor [960 Horizontal Pixels]
- 720 TVL [B/W], 700 TVL [Color]
- 2.8~12mm Varifocal Lens [B6563DIR]
- 5~50mm Varifocal Lens [B6563TIR550]
- 100ft Range Smart IR [B6563DIR]
- 150ft Range Smart IR [B6563DIR]
- Electronic Day & Night [B6563DIR]
- True Day & Night [B6563TIR550]
- 3D DNR [3D Digital Noise Reduction]
- Star-Light [Super Low Light Technology]
- HME [Highlight Masking Exposure]
- SLC [Side Light Compensation]
- Auto Sensing 24VAC/12VDC with Line Lock
- IP66 Certified [Weather Resistant]

Specifications

VIDEO	
Image Sensor	960H CCD
Total Pixels	960 (H) x 478 (V)
Scanning System	2 : 1 Interlace
Frequency	15.734KHz (H), 59.95Hz (V)
Synchronization	Internal or Line Lock
Horizontal Resolution	720 TV Lines [B/W], 700 TV Lines [Color]
Minimum Illumination	F1.2 (30IRE): 0.0 Lux
S/N Ratio	52dB (AGC off)
Video Output	CVBS: 1.0Vp-p / 75 Ω
LENS	
Focal Length	2.8~11mm [B6563DIR] 5~50mm [B6563TIR550]
Lens Type	Varifocal Auto Iris Lens
IR Distance	100ft Range IR [B6563DIR] 150ft Range IR [B6563TIR550]
ENVIRONMENTAL	
Operating Temperature	-10°C ~ 50°C (14°F ~ 122°F)
Operating Humidity	Less than 90% (Non-Condensing)
IP Rating	IP66 (Protects against dust and high pressure water.)

Value 960H Outdoor Vandal Dome Camera V562D/DIR



- 960H Image Sensor [960 Horizontal Pixels]
- 720 TVL [B/W], 700 TVL [Color]
- 2.8~11mm Varifocal Auto Iris Lens
- Electronic Day and Night
- 85ft Range IR, Smart IR
- HME [Highlight Masking Exposure]
- BLC [Back Light Compensation]
- IP66 Certified [Weatherproof]
- Auto Sensing 24VAC/12VDC

Specifications

VIDEO	
Image Sensor	960H CCD
Total Pixels	1020 (H) x 507 (V), 520K Pixels
Frequency	15.734KHz (H), 59.95Hz (V)
Horizontal Resolution	700 TV Lines [B/W], 650 TV Lines [Color]
Minimum Illumination	F1.2 (30IRE): 0.3 Lux [Color] F1.2 (30IRE): 0.0 Lux [B/W]
S/N Ratio	50dB (AGC off)
Video Output	CVBS: 1.0Vp-p / 75 Ω
LENS	
Focal Length	3.3-12mm, DC Auto Iris
IR Distance	85ft Range IR
ENVIRONMENTAL	
IP Rating	IP66 (Protects against dust and high pressure water.)

INFINITY 960H Series Comparison Chart

Image Sensor: 960HCCD Image Sensor 720TV Lines [B/W], 700TV Lines [Color]

	Model #	SnapIt	Lens	Vandal	IR	Day/ Night	WDR/ BLC/ DRC/DNR	Starlight
Infinity 960H	B1567WD	x	3.3 ~ 12mm	IP66	x	Electronic	EWDR, BLC, Smart DNR	o
	B1567WTIR	x	3.3 ~ 12mm	IP66	100ft	TDN	EWDR, BLC, Smart DNR	o
	D4567WD	o	3.3 ~ 12mm	x	x	Electronic	EWDR, BLC, Smart DNR	o
	D4567WTIR	o	3.3 ~ 12mm	x	70ft	TDN	EWDR, BLC, Smart DNR	o
	V4567WD	o	3.3 ~ 12mm	IP68	x	Electronic	EWDR, BLC, Smart DNR	o
	V4567WTIR	o	3.3 ~ 12mm	IP68	70ft	TDN	EWDR, BLC, Smart DNR	o
Starlight 960H	BL2553DIR	x	3.6mm Fixed	IP66	50ft	Electroic	BLC, DRC, 3D-DNR	o
	B6563DIR	x	2.8~12mm	IP66	100ft	Electronic	BLC, DRC, 3D-DNR	o
	B6563TIR550	x	5~50mm	IP66	150ft	TDN	BLC, DRC, 3D-DNR	o
	D3563D	x	2.8~12mm	x	x	Electronic	BLC, DRC, 3D-DNR	o
	D3563DIR	x	2.8~12mm	x	100ft	Electronic	BLC, DRC, 3D-DNR	o
	V6553D	x	3.6mm Fixed	IP66	x	Electronic	BLC, DRC, 3D-DNR	o
	V6553DIR	x	3.6mm Fixed	IP66	100ft	Electronic	BLC, DRC, 3D-DNR	o
	V6563D	x	2.8~12mm	IP66	x	Electronic	BLC, DRC, 3D-DNR	o
	V6563DIR	x	2.8~12mm	IP66	100ft	Electronic	BLC, DRC, 3D-DNR	o
Value 960H	B1562DIR	x	3.3 ~ 12mm	IP66	85ft	Electronic	BLC, DRC, 2D-DNR	x
	D562D	x	2.8 ~ 11mm	x	x	Electronic	BLC, DRC, 2D-DNR	x
	D562DIR	x	2.8 ~ 11mm	x	85ft	Electroic	BLC, DRC, 2D-DNR	x
	V562D	x	2.8 ~ 11mm	IP66	x	Electronic	BLC, DRC, 2D-DNR	x
	V562DIR	x	2.8 ~ 11mm	IP66	85ft	Electronic	BLC, DRC, 2D-DNR	x

o = Included
x = Not Available

Note: The Value Line camera's housing type number has been omitted from the part number for simplicity.

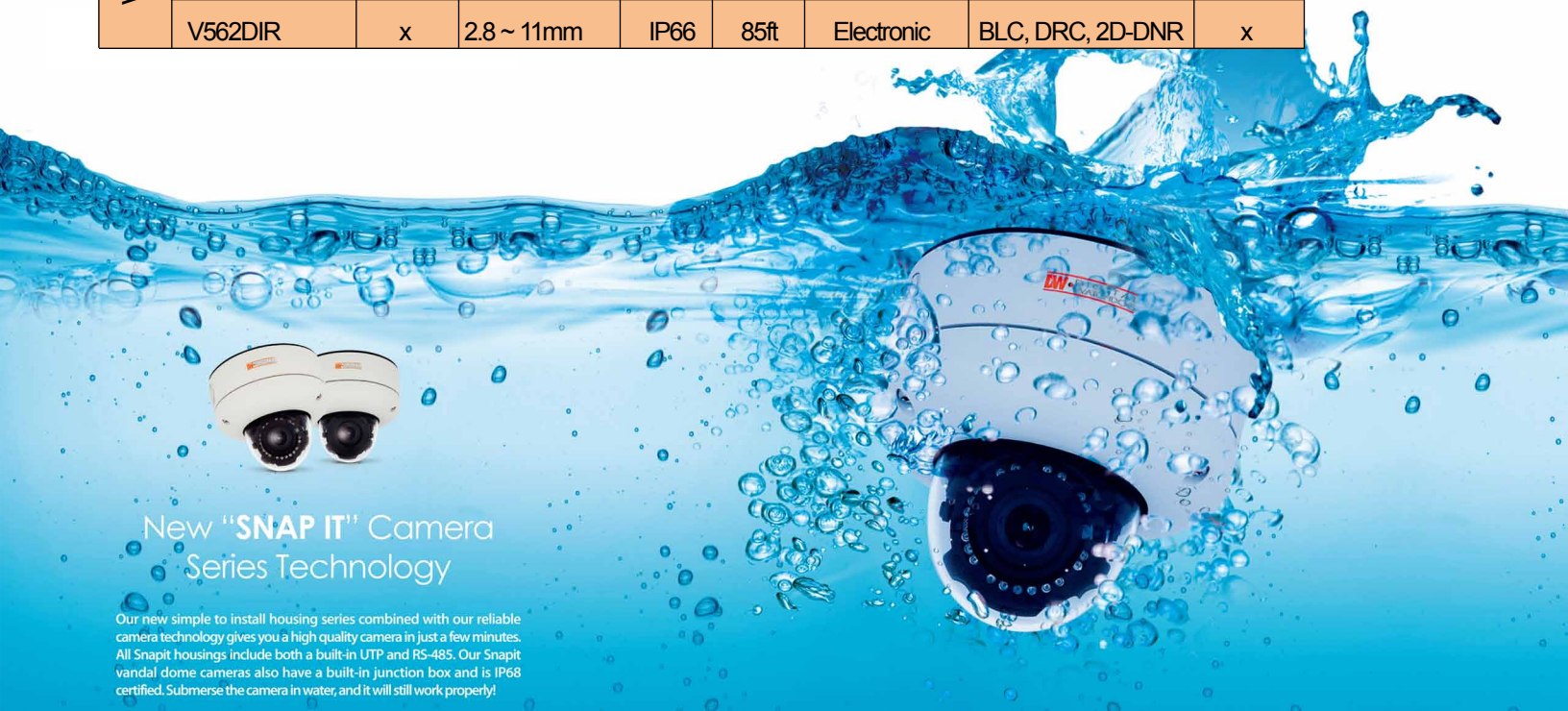

New "SNAP IT" Camera Series Technology

Our new simple to install housing series combined with our reliable camera technology gives you a high quality camera in just a few minutes. All Snapit housings include both a built-in UTP and RS-485. Our Snapit vandal dome cameras also have a built-in junction box and is IP68 certified. Submerge the camera in water, and it will still work properly!