

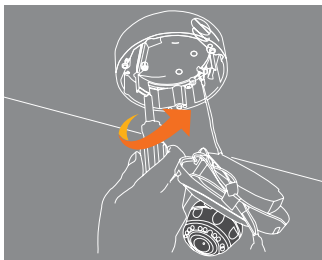

*It's quick. It's easy!*

**Snapit**

Easy Installation 1 2 3 4



1 Junction Box Installation

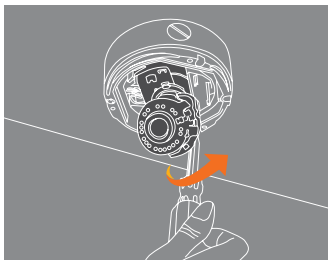

2 Snap It

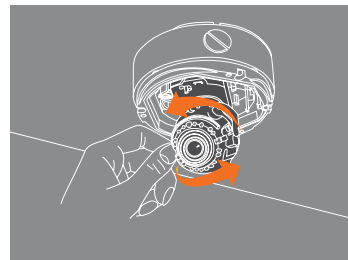

3 Adjustment

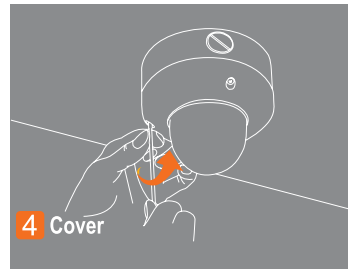

4 Cover

Vandal Dome Camera

**V4382D**

IP68 Weather Proof Rated



**DW** DIGITAL  
WATCHDOG  
Everything's Digital



# OMNI-PLUS™

## OMNI Focus Lens

Crisp, clear, always in focus. Utilizes three lenses to view fore-, mid-, and background as one. Each camera provides 20/20 precision in all your surveillance applications.



## Intelligent Motion Detection

When motion is detected in a viewing area, the lens optically zooms in up to 3X for a programmable period of time and then returns to its normal condition



## IR Remote Programming

OMNI Focus Series Cameras can be programmed and customized for each application with our complimentary IR Remote. Programming is achieved from line of sight to 90° from the camera.



# INFINITY

## Smart IR - See what is really happening at night.

The breakdown of the video image into five zones allows for an even distribution of the IR, which prevents excessive illumination.



## EWDR (Electronic Wide Dynamic Range)

Enables the camera to capture perfect images in both bright and dark environments simultaneously.



## HME (Highlight Masking Exposure)

Masks overly exposed light to produce a true video image of any environment.



## DSS (Digital Slow Shutter)

Along with 3D-DNR, Digital Slow Shutter Technology is the primary technology we employ in our Star-Light functioning cameras.



## Programmable Privacy Zone

When privacy is a concern, monitoring can be masked in certain zones within the scene. The user can define up to 6 rectangular exclusions.



## 3D-DNR (Digital Noise Reduction)

Produces less noise and more color at night. An excellent choice.



## DIS (Digital Image Stabilizer)

Removes the jitters caused by movement or vibrations and reduces the amount of HDD space needed to store recorded data.



## RS485 Set-Up and Programming

For quick installation and programming, up to 256 units can be daisy chained together from most of the standard PTZ control keyboards.



## New ICON Driven OSD Menu

ICON Type Menu will easily guide you through programming options. Simple and fast programming.





## Dimensions

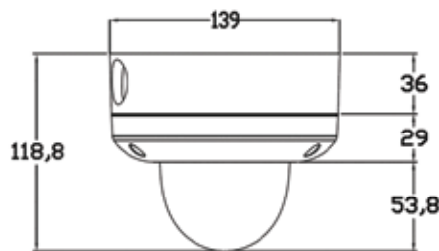

## Summary

Our new simple to install housing series combined with our reliable camera technology series gives you a high quality camera in just a few minutes. All Snapit housings include both a built-in UTP and RS-485. Our Snapit vandal dome cameras also have a built-in junction box and is IP68 certified. Submerge the camera in water, and it will still work properly!

Our Snapit Vandal Dome V4382D is powered by our Infinity OMNI-Plus technology. The technology simplifies field of view adjustment by offering an OMNI-Focus lens which utilizes three lenses to view fore-, mid-, and background as one.

## Features

- 1/3" Sony Super II HAD CCD
- 580 TV Lines
- OMNI-Focus 2.9~8.5mm 3X Motorized Zoom, Auto Iris
- Electronic Day and Night
- Star-Light (Super Low Light Technology)
- EWDR (Electronic Wide Dynamic Range)
- 3D-DNR (3D Digital Noise Reduction)
- DIS (Digital Image Stabilizer)
- HME (Highlight Masking Exposure)
- SLC (Side Light Compensation)
- AGC (Auto Gain Control)
- BLC (Back Light Compensation)
- AWB (Auto White Balance)
- Negative Imaging
- Mirror Image Control
- UTP / RS485 Built-in
- Junction Box Built-in
- Programmable Privacy Zone (6) & Motion Detection
- Easy Icon Driven OSD Menu with Built-in Joystick
- Auto-Sensing 24 VAC/12 VDC with Line Lock
- Secondary Video-BNC Output
- IP68 Certified
- CE, FCC, RoHS Certified

### 3 Axis Gimbal

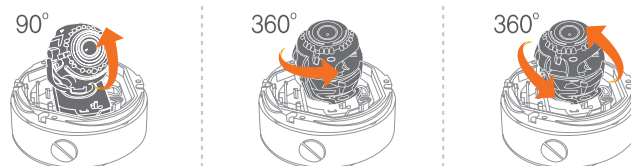

## Popular Accessories

- |            |                                    |
|------------|------------------------------------|
| DWC-FMSNAP | Flush Mount for Snapit Vandal Dome |
| DWC-V1CM   | Pendant Mount Bracket              |
| DWC-V1WM   | Wall Mount Bracket                 |

## Specifications

Model	DWC-V4382D
Image Sensor	1/3" Super II HAD CCD
Pixels-Total (NTSC)	811 (H) X 508 (V)
Pixels-Effective	768 (H) x 494 (V)
Minimum Illumination	0.14Lux (F1.2, 30IRE-COLOR)
	0.0 Lux (LED ON)
Horizontal Resolution	580 TV Lines (COLOR)
	600 TV Lines (BW)
Power Requirement	DC12V / AC24V
Power Consumption	DC12V: 2.1W, 175mA / AC24V: 2.2W, 91.7mA
	DC12V: 4.5W, 375mA / AC24V: 4.6W, 191.7mA LED ON
Shutter Speed	1/60s ~ 1/100000s
S/N Ratio	50dB
Gamma	0.45
Sync System	Internal / Line Lock
Operation Temperature	-29°C ~ +55 °C (-20 °F ~ 131 °F)
Storage Temperature	-20°C ~ +70 °C (-4 °F ~ 158 °F)
Operation Humidity	Under 90% (Non-Condensing)

(\*) Specification is subject to change without prior notice.

