

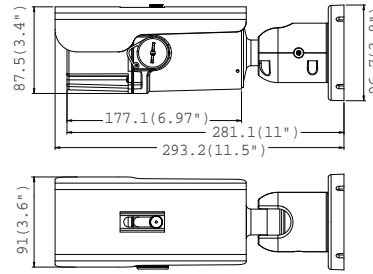

**Dimensions (unit : mm)**



**Specifications**

IMAGE	
Image Sensor	1/2.8" Sony CMOS Sensor
Total Pixels	2016 (H) X 1108 (V)
Minimum Scene Illumination	F1.6 (30IRE): 0.5 Lux [Color] F1.6 (30IRE): 0.01 Lux [B&W]
LENS	
Focal Length	3.5-16mm
Lens Type	Auto Focus
IR Distance	100ft Range IR
Angle of View	Horizontal: 55.4 (wide) - 2.9 (tele)
AUDIO	
Compression and Sampling Rate	G.711 (8KHz)
Input / Output	1 Line In and 1 Line Out Mono
OPERATIONAL	
Brightness	0~20
Shutter Mode	Auto, Manual
Digital Slow Shutter	Off, 2X, 3X, 4X
DNR (Digital Noise Reduction)	Off/ Low/ Middle/ High
Auto Gain Control	0~20
BLC (Back Light Compensation)	Off, On
WDR (Wide Dynamic Range)	Off, On, Level 0~9
Day and Night	Auto, Day (Color), Night (B/W)
Lens Mode	DC/ Manual
Chroma (Hue & Saturation Settings)	0~20
Sharpness	0~10
Mirror & Flip	Off, On
Record Schedule	Continuous, Motion, Sensor, Pre- & Post-Alarm
Alarm Notifications	Notifications Via E-mail
NETWORK	
LAN	802.3 Compliance 10/100 LAN
Video Compression Type	H.264, MPEG4, MJPEG (Super Fine-Low)
Resolution	1920X1080 (16:9) - 320X240 (4:3)
Frame Rate	Up to 30fps at All Resolutions
Streaming Capability	Dual-Stream at Different Rates and Resolutions
IP	IPv4, IPv6
Protocol	TCP/IP, HTTP, DHCP, PPPoE, ICMP, ARP, RARP, RTSP, NTP, UDP, Multicast
Maximum User Access	5 Users
ONVIF Conformance	Yes
Web Viewer	OS: Windows XP / Vista / 7, MAC OS Browser: Internet Explorer, Chrome, Firefox, Safari
Video Management Software	NxMS, DW Spectrum, Pivot
Memory Slot	24 hours recording to Micro SDHC Card (4GB-32GB) Card Not Included*
ENVIRONMENTAL	
Operating Temperature/ Humidity	-29°C ~ 55°C (-20°F ~ 131°F)
Operating Humidity	Less than 90% (Non-Condensing)
Storage Temperature	-29°C ~ 55°C (-20°F ~ 131°F)
IP Rating	IP66/ IP68 (Protects against dust and high pressure water)
Other Certifications	CE, FCC, RoHS
ELECTRICAL	
Power Requirement	DC 12V, PoE (IEEE802.3af Class 3)
Power Consumption	9W, 750mA / LED ON 14.4W, 1200mA
MECHANICAL	
Material	Aluminum Housing
Dimensions	293.2 X 96.7 mm (11.5 X 3.8 in)
Weight	1.52 lbs

**Summary**

The MB421TIR MEGAPIX camera is a triple codec network camera that provides 1080P megapixel resolution at 30 frames per second. The camera's advanced technologies like True Day and Night, 3D-DNR, WDR, and Smart IR will deliver the best images in any type of environment. And Power over Ethernet will simplify installation by connecting both power and network through a single cable.

**Features**

- ONVIF Compliant
- 2.1 Megapixels (1080P, 30fps)
- Triple Codecs (H.264, MJPEG, MPEG4) with Dual-Stream
- 1/2.8" CMOS Sensor (7% Larger Than 1/3" CMOS Sensor)
- 3.5~16mm Auto Focus Lens
- 4X Digital Zoom, 4.5X Optical Zoom
- 100ft IR with Intelligent Camera Sync
- TDN (True Day and Night/TDN5)
- Power over Ethernet [PoE] & DC12V
- Two-Way Audio
- Micro SD/SDHC Class 10 Card for Emergency Backup
- IP66/ IP68 Certified (Weatherproof)
- No Fog or Condensation under Any Weather Conditions
- Web Server Built-in
- WDR (Wide Dynamic Range)
- 3D-DNR (3D Digital Noise Reduction)
- Programmable Privacy Zones (30) & Motion Detection

**Accessories (Optional)**

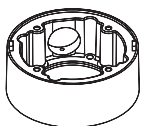

DWC-BLJUNC  
Junction Box for Bullet Housing

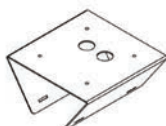

DWC-PMB-BU  
Pole Mount for Bullet Housing

\*Specification is subject to change without prior notice.